

### LEGEND

FINISHED SURFACE  
CONTOURS (1m INTERVAL)

FILL DEPTH (to nearest 100mm)

STREETLIGHT

### STREET TREE

DRIVEWAY (BY PURCHASER)

PATH

—590—

11

x 0.5



BLOCK AREA / BOUNDARY LENGTH

3.5m COMBINED EASEMENT UNO  
(Sewer and Stormwater)

BUSHFIRE ATTACK LEVEL

BLOCK NUMBER

STORMWATER, SEWER, WATER

## REFERENCES

400m<sup>2</sup> 4.54

---

BAI 12.5

802



## NOTES

1. THIS PLAN ONLY INDICATES AREA OF FILL OF WHICH THE DEVELOPER AND ITS AGENTS ARE AWARE. IT HAS NOT BEEN CHECKED BY THE DEVELOPER, AND THE DEVELOPER DOES NOT GUARANTEE ITS ACCURACY. IN NO WAY SHOULD THIS PLAN BE READ AS A CONCLUSIVE STATEMENT OF THE FULL EXTENT OF THE FILL THAT MAY BE FOUND ON THE WHOLE LAND DEPICTED. LESSEES AND PURCHASERS SHOULD MAKE THEIR OWN INQUIRIES IN REGARD TO THE EXACT DRAINAGE, GEOTECHNICAL AND FILL CONDITIONS AFFECTING THEIR BLOCKS.
2. STREET TREES, STREET LIGHTS AND SUBSTATION LOCATIONS ARE INDICATIVE ONLY.

REVISION: 1

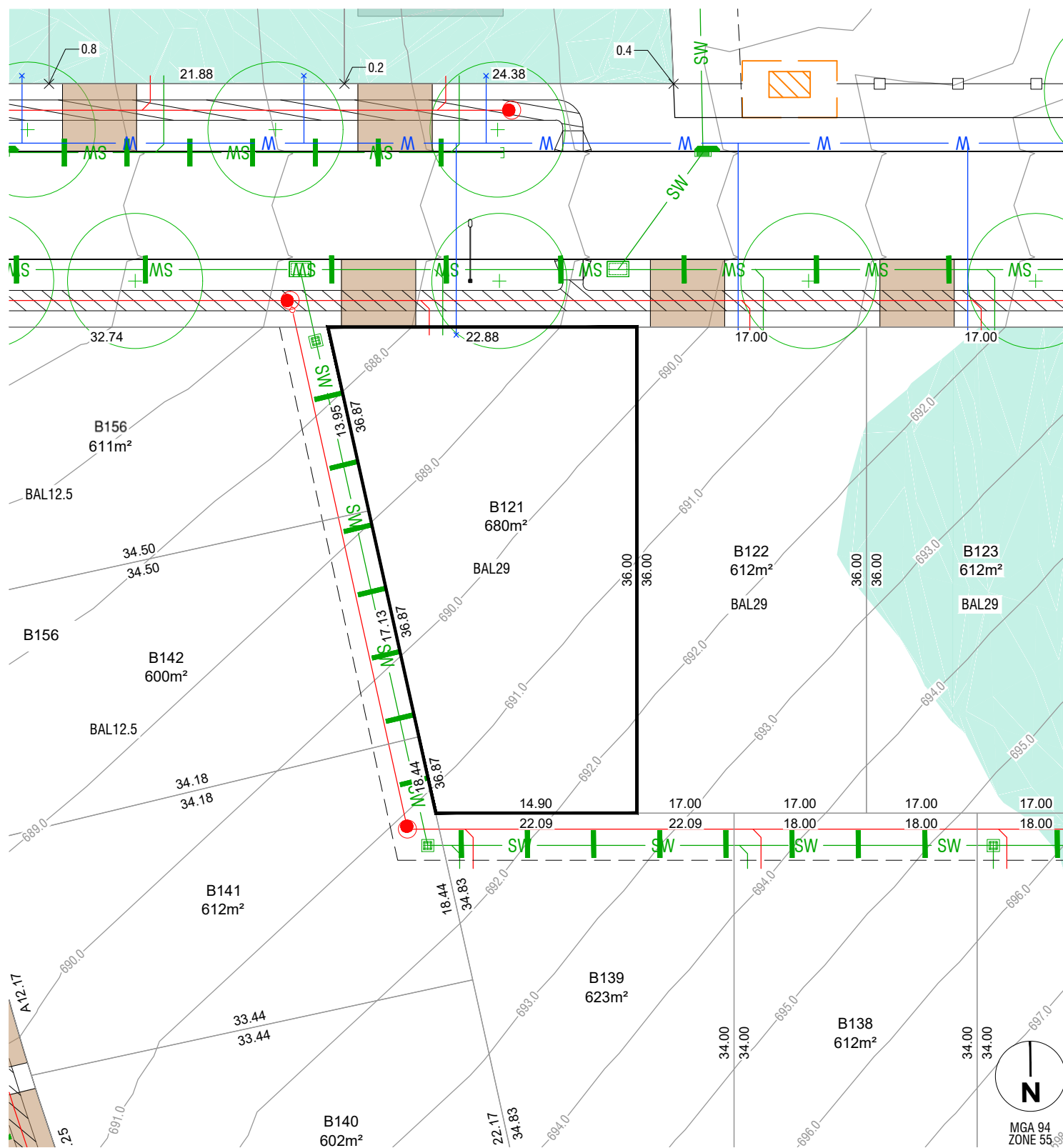

### LEGEND

FINISHED SURFACE  
CONTOURS (1m INTERVAL)

FILL

FILL DEPTH (to nearest 100mm)

STREETLIGHT

## STREET TREE

DRIVEWAY (BY PURCHASER)

PATH

—590—

x 0.5



BLOCK AREA / BOUNDARY LENGTH

3.5m COMBINED EASEMENT UNO  
(Sewer and Stormwater)

BUSHFIRE ATTACK LEVEL

BLOCK NUMBER

STORMWATER, SEWER, WATER  
TIES

SUBSTATION

400m<sup>2</sup> 4.54

BAL 1

802



## NOTES

1. THIS PLAN ONLY INDICATES AREA OF FILL OF WHICH THE DEVELOPER AND ITS AGENTS ARE AWARE. IT HAS NOT BEEN CHECKED BY THE DEVELOPER, AND THE DEVELOPER DOES NOT GUARANTEE ITS ACCURACY. IN NO WAY SHOULD THIS PLAN BE READ AS A CONCLUSIVE STATEMENT OF THE FULL EXTENT OF THE FILL THAT MAY BE FOUND ON THE WHOLE LAND DEPICTED. LESSEES AND PURCHASERS SHOULD MAKE THEIR OWN INQUIRIES IN REGARD TO THE EXACT DRAINAGE, GEOTECHNICAL AND FILL CONDITIONS AFFECTING THEIR BLOCKS.
2. STREET TREES, STREET LIGHTS AND SUBSTATION LOCATIONS ARE INDICATIVE ONLY.

REVISION: 1



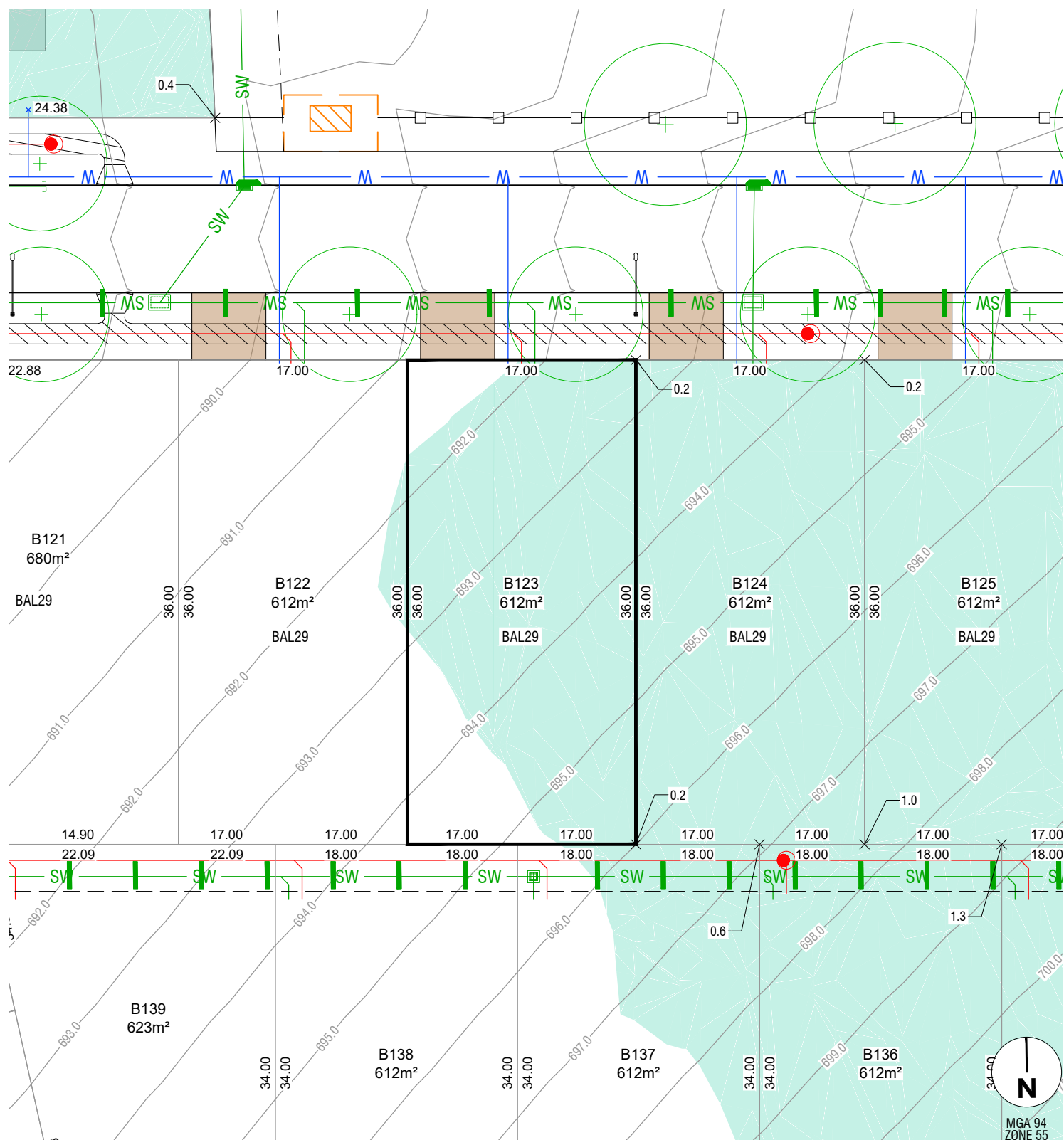

### LEGEND

FINISHED SURFACE  
CONTOURS (1m INTERVAL)

FILL

FILL DEPTH (to nearest 100mm)

STREETLIGHT

STREET TREE

DRIVEWAY (BY PURCHASER)

PATH

—590—

Page 10 of 10

x 0.5



BLOCK AREA / BOUNDARY LENGTH

3.5m COMBINED EASEMENT UNO  
(Sewer and Stormwater)

BUSHFIRE ATTACK LEVEL

BLOCK NUMBER

STORMWATER, SEWER, WATER  
TIES

SUBSTATION

400m<sup>2</sup> 4.54

---

RAI 12.5

802



## NOTES

1. THIS PLAN ONLY INDICATES AREA OF FILL OF WHICH THE DEVELOPER AND ITS AGENTS ARE AWARE. IT HAS NOT BEEN CHECKED BY THE DEVELOPER, AND THE DEVELOPER DOES NOT GUARANTEE ITS ACCURACY. IN NO WAY SHOULD THIS PLAN BE READ AS A CONCLUSIVE STATEMENT OF THE FULL EXTENT OF THE FILL THAT MAY BE FOUND ON THE WHOLE LAND DEPICTED. LESSEES AND PURCHASERS SHOULD MAKE THEIR OWN INQUIRIES IN REGARD TO THE EXACT DRAINAGE, GEOTECHNICAL AND FILL CONDITIONS AFFECTING THEIR BLOCKS.
2. STREET TREES, STREET LIGHTS AND SUBSTATION LOCATIONS ARE INDICATIVE ONLY.

REVISION: 1



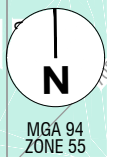

## NOTES

400m<sup>2</sup> 4.54

---

802

1 2 3



2. STREET TREES, STREET LIGHTS AND SUBSTATION LOCATIONS ARE INDICATIVE ONLY.

© Spiire Australia Pty Ltd All Rights Reserved

This document is produced by Spiire Australia Pty Ltd solely for the benefit of and use by the client in accordance with the terms of the retainer. Spiire Australia Pty Ltd does not and shall not assume any responsibility or liability whatsoever to any third party arising out of any use or reliance by third party on the content of this document.



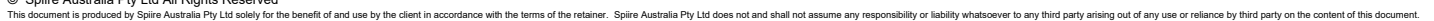

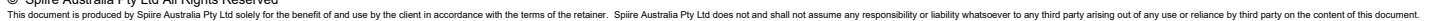



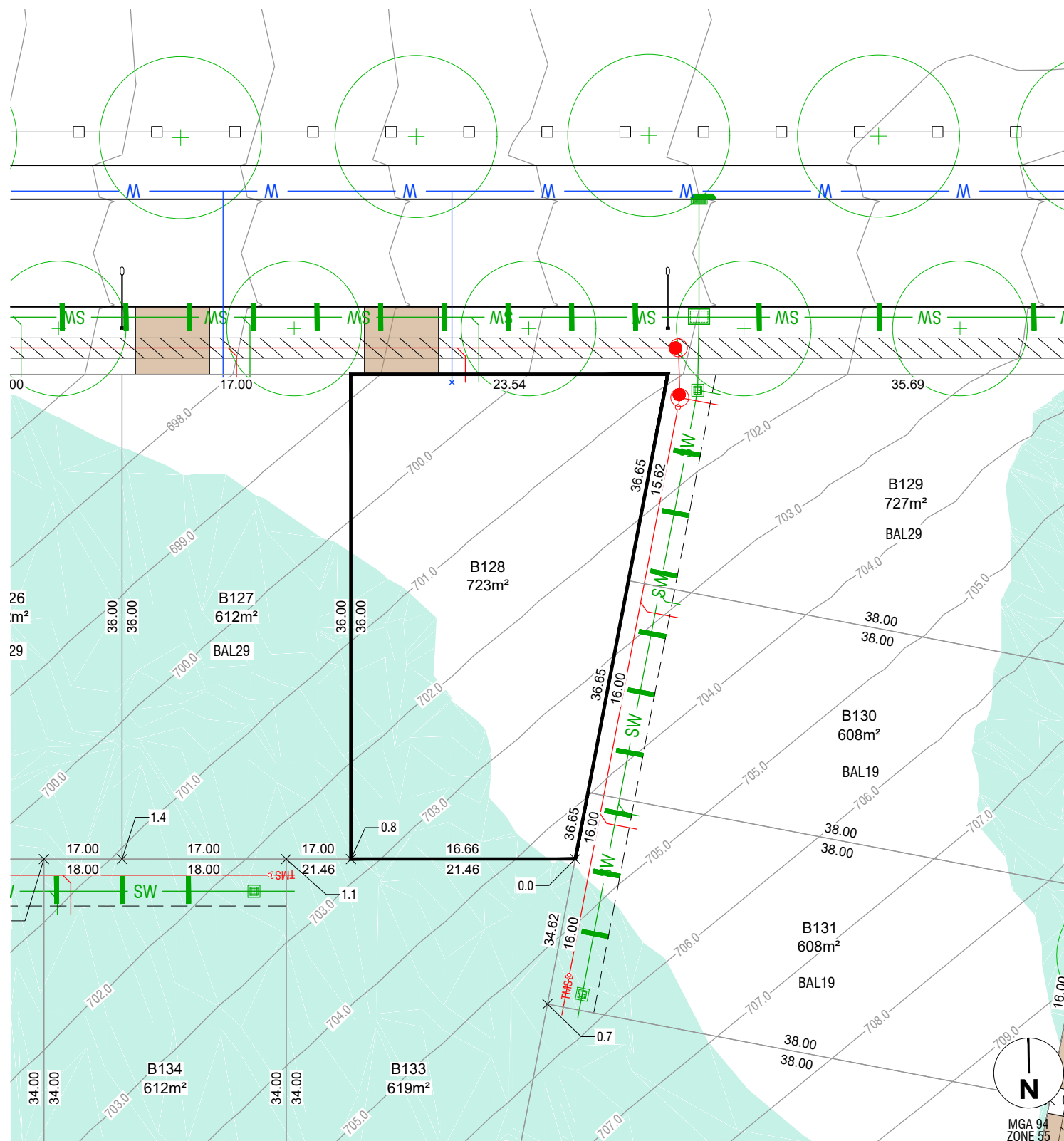

## PATH



SUBSTATION

11

1. THIS PLAN ONLY INDICATES AREA OF FILL OF WHICH THE DEVELOPER AND ITS AGENTS ARE AWARE. IT HAS NOT BEEN CHECKED BY THE DEVELOPER, AND THE DEVELOPER DOES NOT GUARANTEE ITS ACCURACY. IN NO WAY SHOULD THIS PLAN BE READ AS A CONCLUSIVE STATEMENT OF THE FULL EXTENT OF THE FILL THAT MAY BE FOUND ON THE WHOLE LAND DEPICTED. LESSEES AND PURCHASERS SHOULD MAKE THEIR OWN INQUIRIES IN REGARD TO THE EXACT DRAINAGE, GEOTECHNICAL AND FILL CONDITIONS AFFECTING THEIR BLOCKS.
2. STREET TREES, STREET LIGHTS AND SUBSTATION LOCATIONS ARE INDICATIVE ONLY.

REVISION: 1

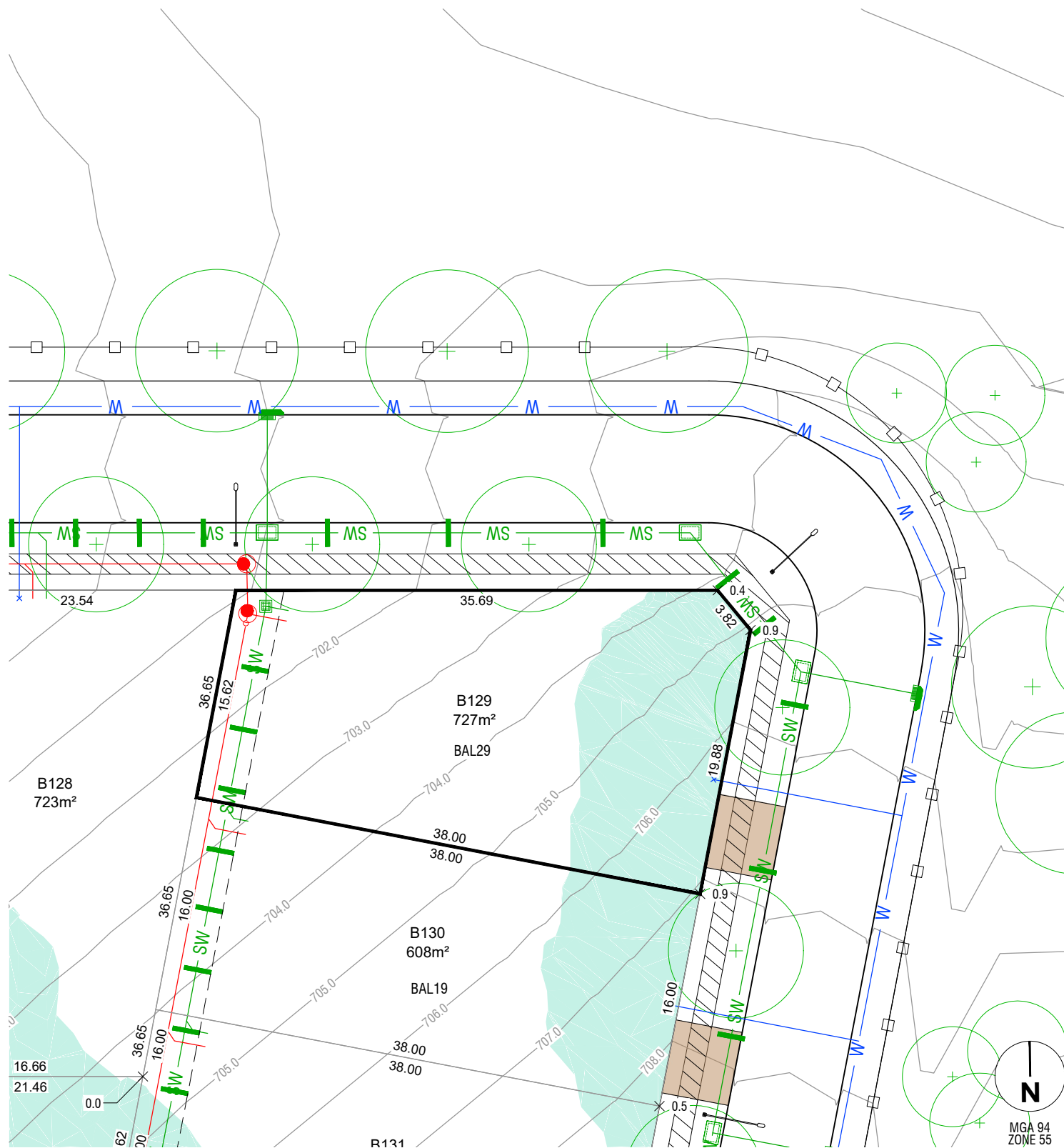

### LEGEND

FINISHED SURFACE  
CONTOURS (1m INTERVAL)

FILL

FILL DEPTH (to nearest 100mm)

STREETLIGHT

STREET TREE

DRIVEWAY (BY PURCHASER)

PATH

—590—

---

2.5

x 0.5



BLOCK AREA / BOUNDARY LENGTH

3.5m COMBINED EASEMENT UNO  
(Sewer and Stormwater)

BUSHFIRE ATTACK LEVEL

BLOCK NUMBER

STORMWATER, SEWER, WATER  
TIES

SUBSTATION

400m<sup>2</sup> 4.54

Room 4.04

---

— — — — —

BAL 12.5

802



100

## NOTES

1. THIS PLAN ONLY INDICATES AREA OF FILL OF WHICH THE DEVELOPER AND ITS AGENTS ARE AWARE. IT HAS NOT BEEN CHECKED BY THE DEVELOPER, AND THE DEVELOPER DOES NOT GUARANTEE ITS ACCURACY. IN NO WAY SHOULD THIS PLAN BE READ AS A CONCLUSIVE STATEMENT OF THE FULL EXTENT OF THE FILL THAT MAY BE FOUND ON THE WHOLE LAND DEPICTED. LESSEES AND PURCHASERS SHOULD MAKE THEIR OWN INQUIRIES IN REGARD TO THE EXACT DRAINAGE, GEOTECHNICAL AND FILL CONDITIONS AFFECTING THEIR BLOCKS.
2. STREET TREES, STREET LIGHTS AND SUBSTATION LOCATIONS ARE INDICATIVE ONLY.

REVISION: 1

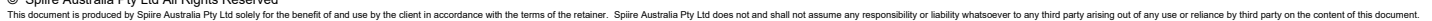



## NOTES

- REVISION: 1



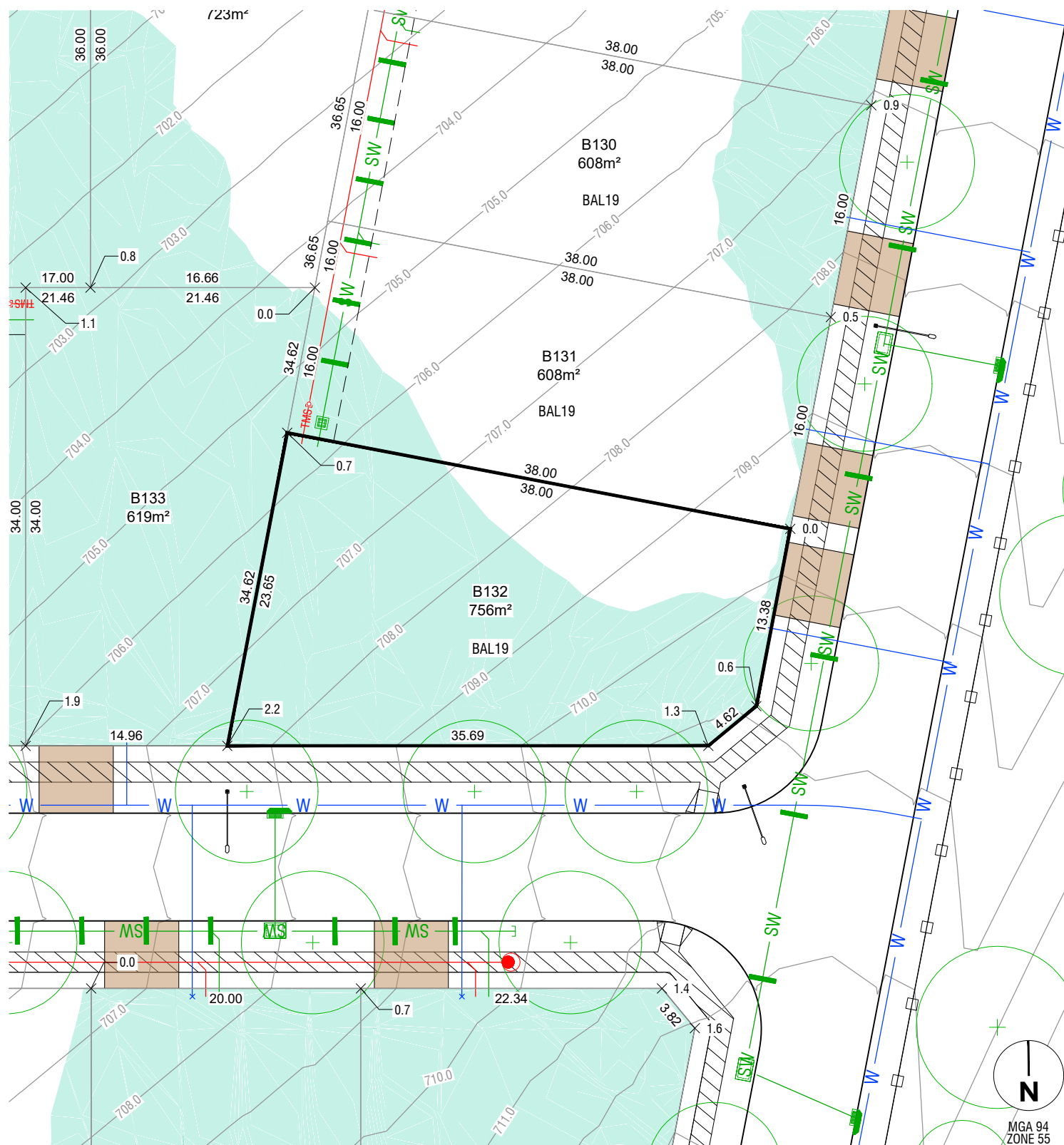

### LEGEND

FINISHED SURFACE  
CONTOURS (1m INTERVAL)

FILL

FILL DEPTH (to nearest 100mm)

STREETLIGHT

## STREET TREE

DRIVEWAY (BY PURCHASER)

PATH

—590—

Page 10 of 10

x 0.5



BLOCK AREA / BOUNDARY LENGTH

3.5m COMBINED EASEMENT UNO  
(Sewer and Stormwater)

BUSHFIRE ATTACK LEVEL

BLOCK NUMBER

## STORMWATER, SEWER, WATER TIES

SUBSTATION

400m<sup>2</sup> 4.54

---

RAI 12.5

802



11

## NOTES

1. THIS PLAN ONLY INDICATES AREA OF FILL OF WHICH THE DEVELOPER AND ITS AGENTS ARE AWARE. IT HAS NOT BEEN CHECKED BY THE DEVELOPER, AND THE DEVELOPER DOES NOT GUARANTEE ITS ACCURACY. IN NO WAY SHOULD THIS PLAN BE READ AS A CONCLUSIVE STATEMENT OF THE FULL EXTENT OF THE FILL THAT MAY BE FOUND ON THE WHOLE LAND DEPICTED. LESSEES AND PURCHASERS SHOULD MAKE THEIR OWN INQUIRIES IN REGARD TO THE EXACT DRAINAGE, GEOTECHNICAL AND FILL CONDITIONS AFFECTING THEIR BLOCKS.
2. STREET TREES, STREET LIGHTS AND SUBSTATION LOCATIONS ARE INDICATIVE ONLY.

REVISION: 1

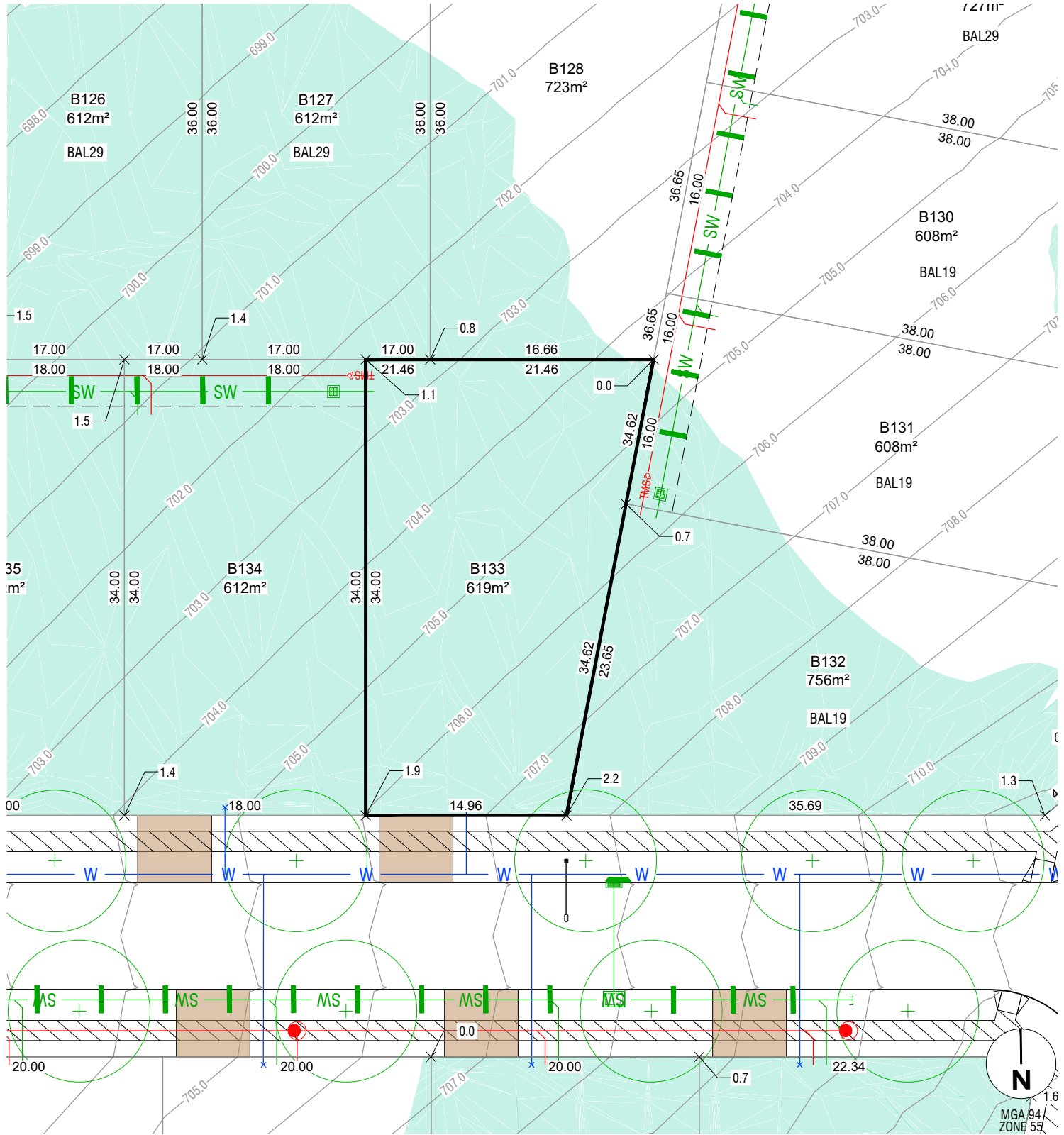

LEGEND

FINISHED SURFACE	590	BLOCK AREA / BOUNDARY LENGTH	400m² 4.54
CONTOURS (1m INTERVAL)		3.5m COMBINED EASEMENT UNO (Sewer and Stormwater)	BAL 12.5
FILL		BUSHFIRE ATTACK LEVEL	802
FILL DEPTH (to nearest 100mm)	x 0.5	BLOCK NUMBER	
STREETLIGHT		STORMWATER, SEWER, WATER TIES	
STREET TREE		SUBSTATION	
DRIVEWAY (BY PURCHASER)			
PATH			

NOTES

- THIS PLAN ONLY INDICATES AREA OF FILL OF WHICH THE DEVELOPER AND ITS AGENTS ARE AWARE. IT HAS NOT BEEN CHECKED BY THE DEVELOPER, AND THE DEVELOPER DOES NOT GUARANTEE ITS ACCURACY. IN NO WAY SHOULD THIS PLAN BE READ AS A CONCLUSIVE STATEMENT OF THE FULL EXTENT OF THE FILL THAT MAY BE FOUND ON THE WHOLE LAND DEPICTED. LESSEES AND PURCHASERS SHOULD MAKE THEIR OWN INQUIRIES IN REGARD TO THE EXACT DRAINAGE, GEOTECHNICAL AND FILL CONDITIONS AFFECTING THEIR BLOCKS.
- STREET TREES, STREET LIGHTS AND SUBSTATION LOCATIONS ARE INDICATIVE ONLY.

REVISION: 1

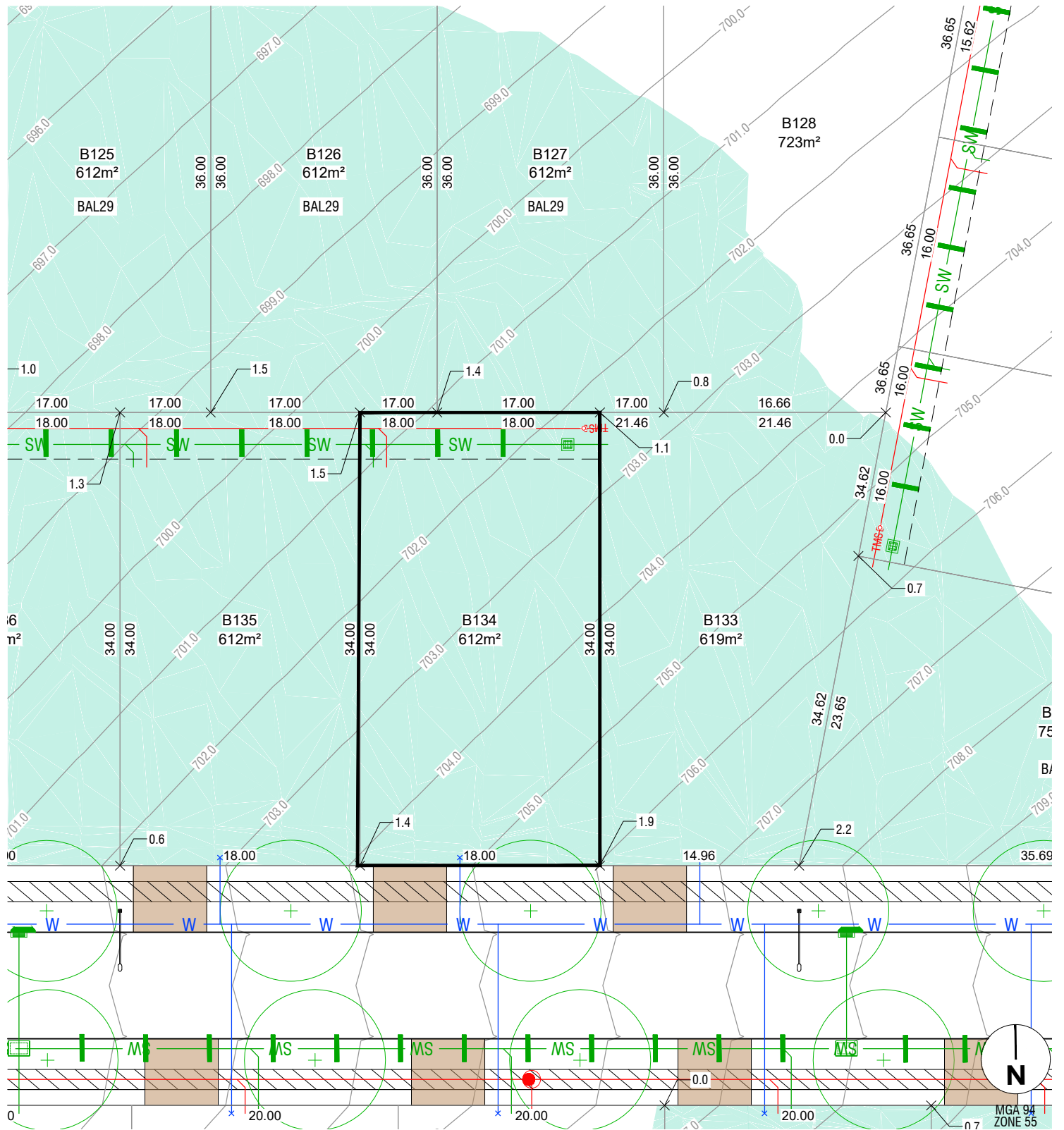

## LEGEND

FINISHED SURFACE  
CONTOURS (1m INTERVAL)

FILL  
FILL DEPTH (to nearest 100mm)

STREETLIGHT

STREET TREE

DRIVEWAY (BY PURCHASER)

PATH

590

x 0.5

802

802

802

802

802

BLOCK AREA / BOUNDARY LENGTH

3.5m COMBINED EASEMENT UNO  
(Sewer and Stormwater)

BUSHFIRE ATTACK LEVEL

BLOCK NUMBER

STORMWATER, SEWER, WATER  
TIES

SUBSTATION

400m² 4.54

BAL 12.5

802

802

802

802

## NOTES

1. THIS PLAN ONLY INDICATES AREA OF FILL OF WHICH THE DEVELOPER AND ITS AGENTS ARE AWARE. IT HAS NOT BEEN CHECKED BY THE DEVELOPER, AND THE DEVELOPER DOES NOT GUARANTEE ITS ACCURACY. IN NO WAY SHOULD THIS PLAN BE READ AS A CONCLUSIVE STATEMENT OF THE FULL EXTENT OF THE FILL THAT MAY BE FOUND ON THE WHOLE LAND DEPICTED. LESSEES AND PURCHASERS SHOULD MAKE THEIR OWN INQUIRIES IN REGARD TO THE EXACT DRAINAGE, GEOTECHNICAL AND FILL CONDITIONS AFFECTING THEIR BLOCKS.
2. STREET TREES, STREET LIGHTS AND SUBSTATION LOCATIONS ARE INDICATIVE ONLY.

REVISION: 1



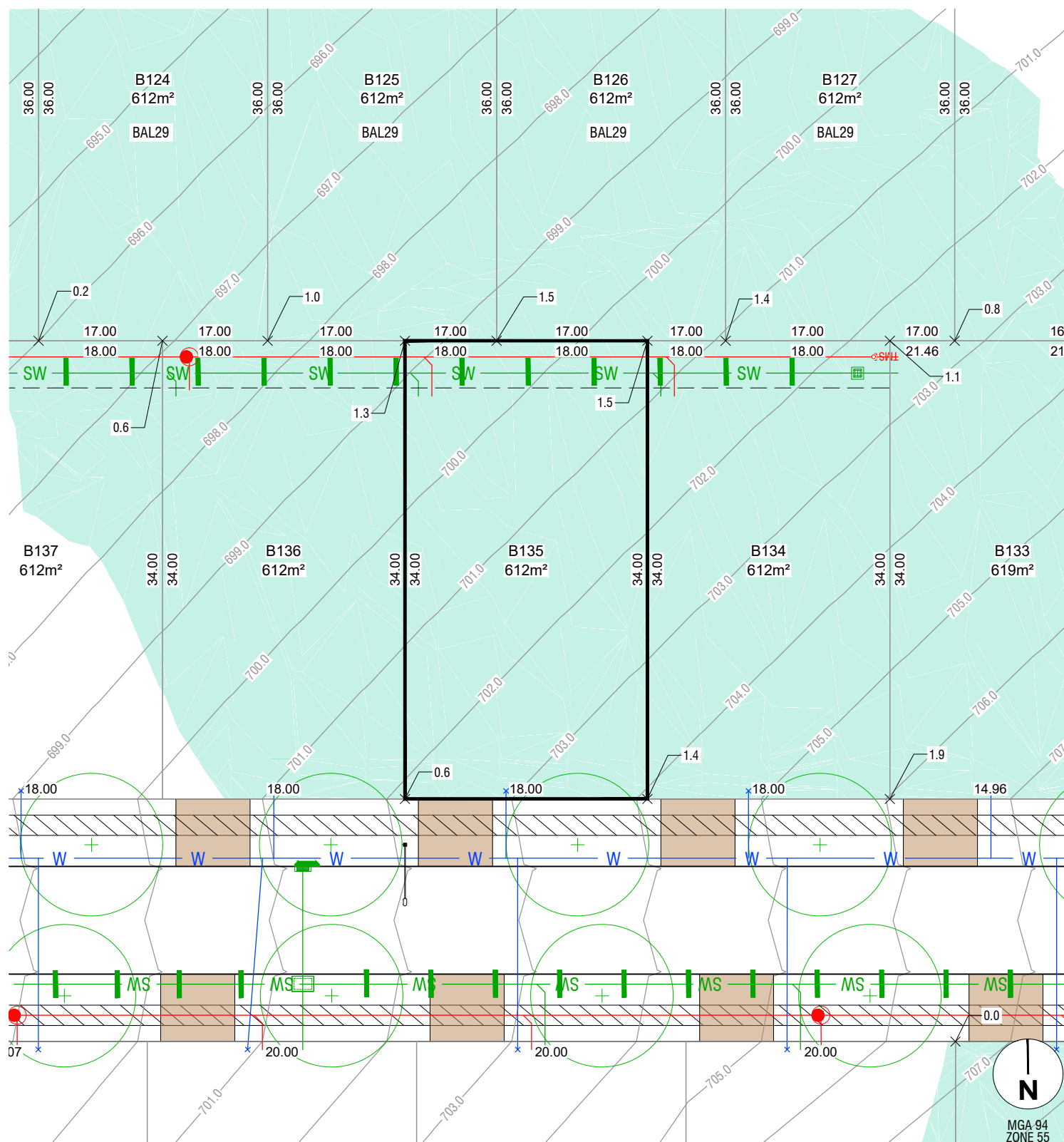

### LEGEND

FINISHED SURFACE  
CONTOURS (1m INTERVAL)

FILL

FILL DEPTH (to nearest 100mm)

STREETLIGHT

STREET TREE

DRIVEWAY (BY PURCHASER)

PATH

—590—

11

—

x 0.5



BLOCK AREA / BOUNDARY LENGTH

3.5m COMBINED EASEMENT UNO  
(Sewer and Stormwater)

BUSHFIRE ATTACK LEVEL

BLOCK NUMBER

BLOCK NUMBER

STORMWATER, SEWER, WATER  
TIES

TIES  
SUBSTATION

400m<sup>2</sup> 4.54

Room 4.04

---

BAI 12.5

0.17

802



1

## NOTES

1. THIS PLAN ONLY INDICATES AREA OF FILL OF WHICH THE DEVELOPER AND ITS AGENTS ARE AWARE. IT HAS NOT BEEN CHECKED BY THE DEVELOPER, AND THE DEVELOPER DOES NOT GUARANTEE ITS ACCURACY. IN NO WAY SHOULD THIS PLAN BE READ AS A CONCLUSIVE STATEMENT OF THE FULL EXTENT OF THE FILL THAT MAY BE FOUND ON THE WHOLE LAND DEPICTED. LESSEES AND PURCHASERS SHOULD MAKE THEIR OWN INQUIRIES IN REGARD TO THE EXACT DRAINAGE, GEOTECHNICAL AND FILL CONDITIONS AFFECTING THEIR BLOCKS.
2. STREET TREES, STREET LIGHTS AND SUBSTATION LOCATIONS ARE INDICATIVE ONLY.

REVISION: 1



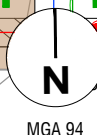

## PATH



SUBSTATION



1. THIS PLAN ONLY INDICATES AREA OF FILL OF WHICH THE DEVELOPER AND ITS AGENTS ARE AWARE. IT HAS NOT BEEN CHECKED BY THE DEVELOPER, AND THE DEVELOPER DOES NOT GUARANTEE ITS ACCURACY. IN NO WAY SHOULD THIS PLAN BE READ AS A CONCLUSIVE STATEMENT OF THE FULL EXTENT OF THE FILL THAT MAY BE FOUND ON THE WHOLE LAND DEPICTED. LESSEES AND PURCHASERS SHOULD MAKE THEIR OWN INQUIRIES IN REGARD TO THE EXACT DRAINAGE, GEOTECHNICAL AND FILL CONDITIONS AFFECTING THEIR BLOCKS.
2. STREET TREES, STREET LIGHTS AND SUBSTATION LOCATIONS ARE INDICATIVE ONLY.

© Spiire Australia Pty Ltd All Rights Reserved

This document is produced by Spiire Australia Pty Ltd solely for the benefit of and use by the client in accordance with the terms of the retainer. Spiire Australia Pty Ltd does not and shall not assume any responsibility or liability whatsoever to any third party arising out of any use or reliance by third party on the content of this document.

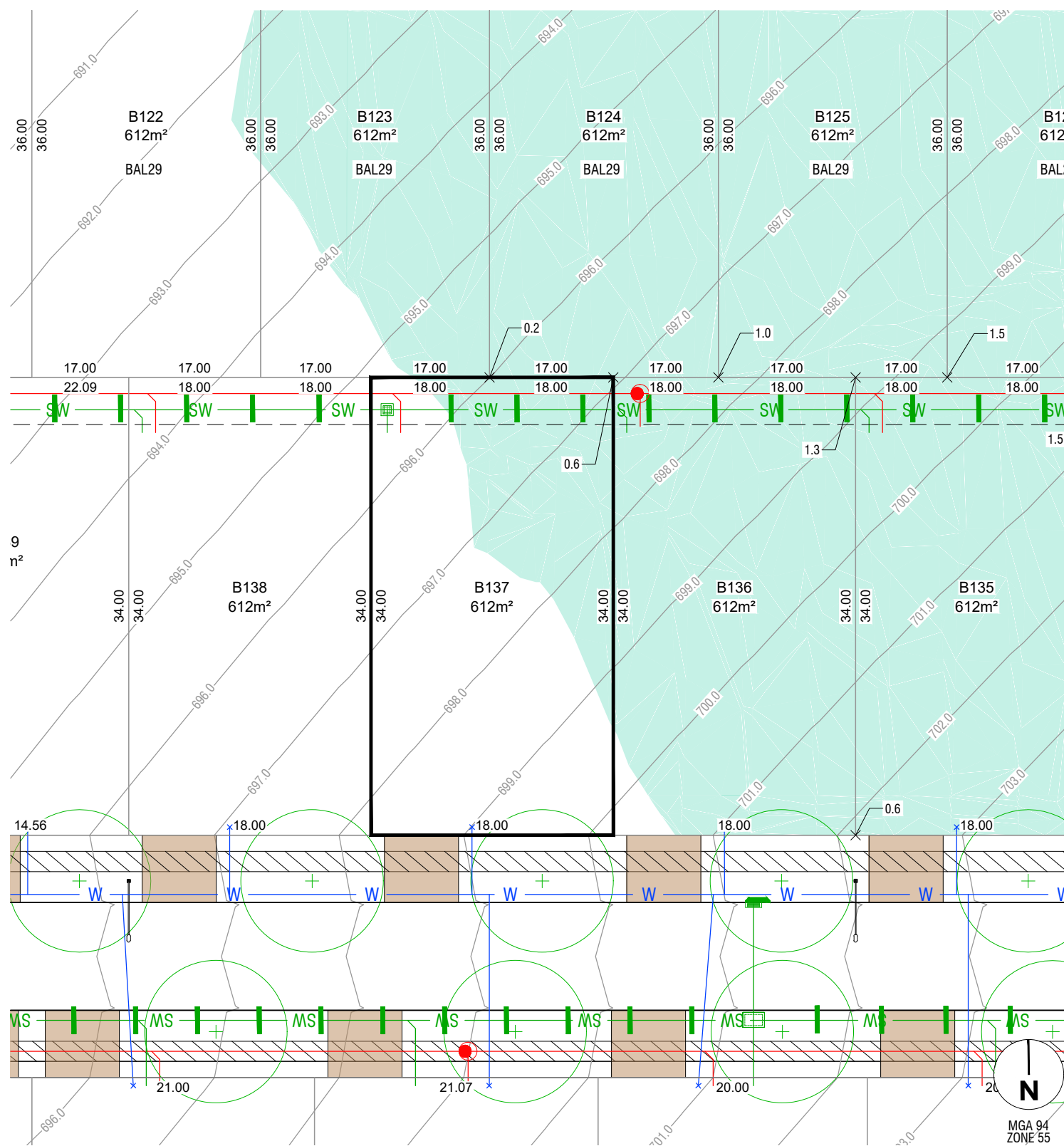

### LEGEND

FINISHED SURFACE  
CONTOURS (1m INTERVAL)

FILL

FILL DEPTH (to nearest 100mm)

STREETLIGHT

## STREET TREE

DRIVEWAY (BY PURCHASER)

PATH

—590—

Page 10

x 0.5



BLOCK AREA / BOUNDARY LENGTH

3.5m COMBINED EASEMENT UNO  
(Sewer and Stormwater)

BUSHFIRE ATTACK LEVEL

BLOCK NUMBER

## STORMWATER, SEWER, WATER TIES

SUBSTATION

400m<sup>2</sup> 4.54

Room 4.04

BAL 12

802

11



## NOTES

1. THIS PLAN ONLY INDICATES AREA OF FILL OF WHICH THE DEVELOPER AND ITS AGENTS ARE AWARE. IT HAS NOT BEEN CHECKED BY THE DEVELOPER, AND THE DEVELOPER DOES NOT GUARANTEE ITS ACCURACY. IN NO WAY SHOULD THIS PLAN BE READ AS A CONCLUSIVE STATEMENT OF THE FULL EXTENT OF THE FILL THAT MAY BE FOUND ON THE WHOLE LAND DEPICTED. LESSEES AND PURCHASERS SHOULD MAKE THEIR OWN INQUIRIES IN REGARD TO THE EXACT DRAINAGE, GEOTECHNICAL AND FILL CONDITIONS AFFECTING THEIR BLOCKS.
2. STREET TREES, STREET LIGHTS AND SUBSTATION LOCATIONS ARE INDICATIVE ONLY.

REVISION: 1

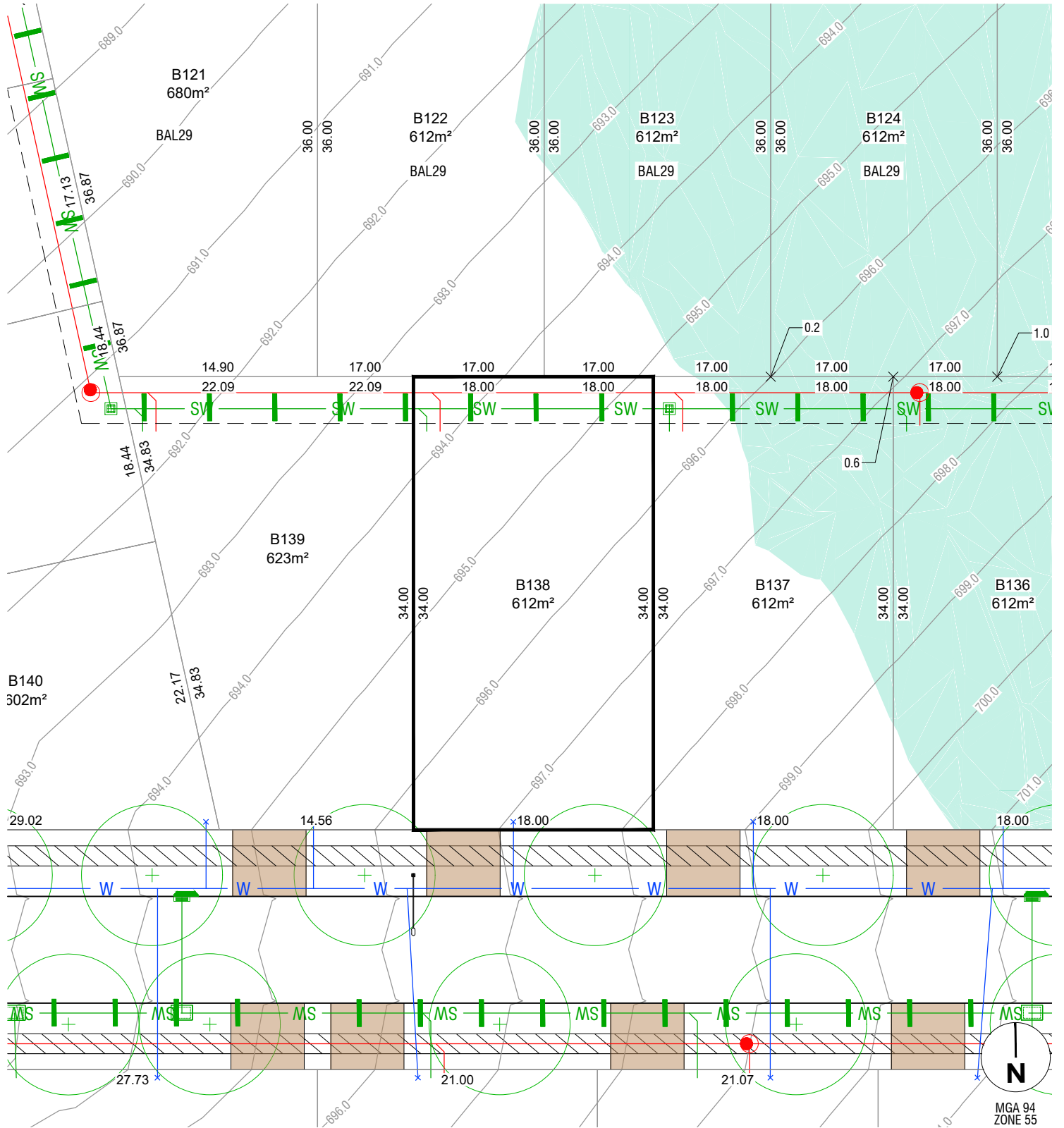

LEGEND

FINISHED SURFACE	— 590 —	BLOCK AREA / BOUNDARY LENGTH	400m <sup>2</sup> 4.54
CONTOURS (1m INTERVAL)		3.5m COMBINED EASEMENT UNO (Sewer and Stormwater)	— 12.5 —
FILL		BUSHFIRE ATTACK LEVEL	802
FILL DEPTH (to nearest 100mm)	x 0.5	BLOCK NUMBER	
STREETLIGHT	— • —	STORMWATER, SEWER, WATER TIES	
STREET TREE	— • —	SUBSTATION	
DRIVEWAY (BY PURCHASER)			
PATH			

NOTES

1. THIS PLAN ONLY INDICATES AREA OF FILL OF WHICH THE DEVELOPER AND ITS AGENTS ARE AWARE. IT HAS NOT BEEN CHECKED BY THE DEVELOPER, AND THE DEVELOPER DOES NOT GUARANTEE ITS ACCURACY. IN NO WAY SHOULD THIS PLAN BE READ AS A CONCLUSIVE STATEMENT OF THE FULL EXTENT OF THE FILL THAT MAY BE FOUND ON THE WHOLE LAND DEPICTED. LESSEES AND PURCHASERS SHOULD MAKE THEIR OWN INQUIRIES IN REGARD TO THE EXACT DRAINAGE, GEOTECHNICAL AND FILL CONDITIONS AFFECTING THEIR BLOCKS.
2. STREET TREES, STREET LIGHTS AND SUBSTATION LOCATIONS ARE INDICATIVE ONLY.

REVISION: 1

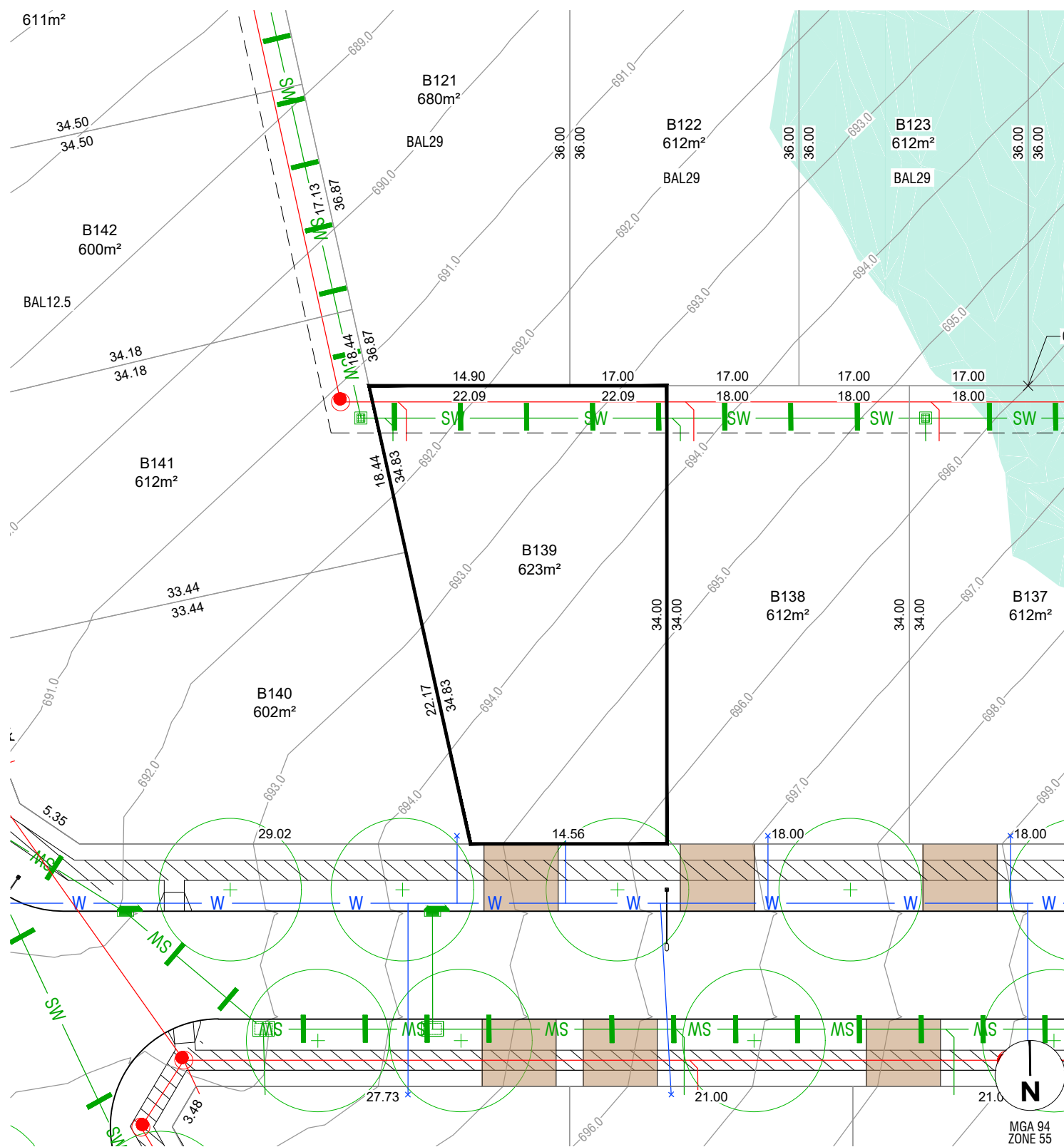

### LEGEND

FINISHED SURFACE  
CONTOURS (1m INTERVAL)

FILL

FILL DEPTH (to nearest 100mm)

STREETLIGHT

## STREET TREE

DRIVEWAY (BY PURCHASER)

PATH

—590—

Page 10 of 10

2.5

x 0.5



BLOCK AREA / BOUNDARY LENGTH

3.5m COMBINED EASEMENT UNO  
(Sewer and Stormwater)

BUSHFIRE ATTACK LEVEL

BLOCK NUMBER

STORMWATER, SEWER, WATER  
TIES

SUBSTATION

400m<sup>2</sup> 4.54

Room 4.04

---

— — — — —

BAL 12.5

802



100

## NOTES

1. THIS PLAN ONLY INDICATES AREA OF FILL OF WHICH THE DEVELOPER AND ITS AGENTS ARE AWARE. IT HAS NOT BEEN CHECKED BY THE DEVELOPER, AND THE DEVELOPER DOES NOT GUARANTEE ITS ACCURACY. IN NO WAY SHOULD THIS PLAN BE READ AS A CONCLUSIVE STATEMENT OF THE FULL EXTENT OF THE FILL THAT MAY BE FOUND ON THE WHOLE LAND DEPICTED. LESSEES AND PURCHASERS SHOULD MAKE THEIR OWN INQUIRIES IN REGARD TO THE EXACT DRAINAGE, GEOTECHNICAL AND FILL CONDITIONS AFFECTING THEIR BLOCKS.
2. STREET TREES, STREET LIGHTS AND SUBSTATION LOCATIONS ARE INDICATIVE ONLY.

REVISION: 1



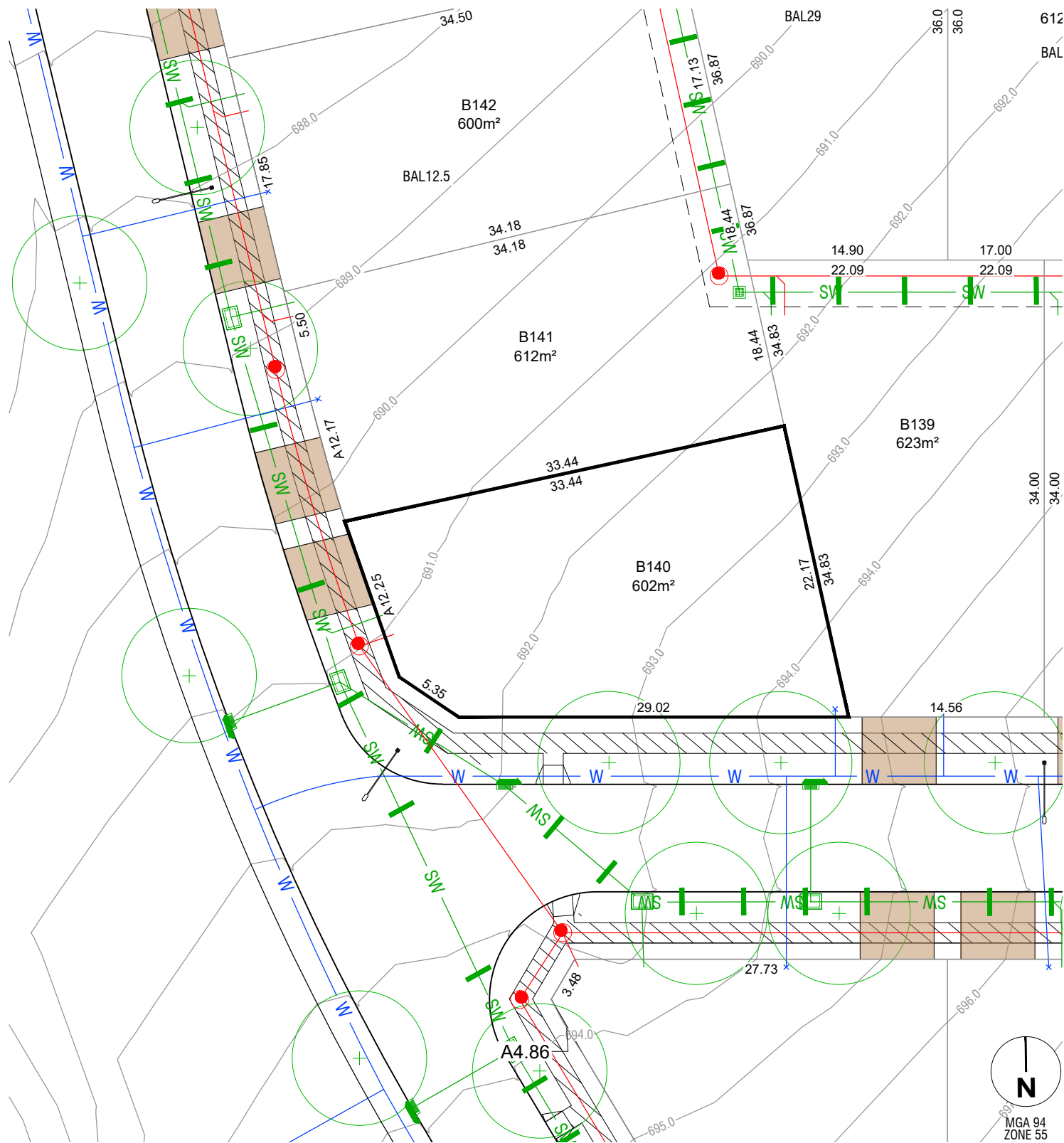

### LEGEND

FINISHED SURFACE  
CONTOURS (1m INTERVAL)

FILL

FILL DEPTH (to nearest 100mm)

STREETLIGHT

STREET TREE

DRIVEWAY (BY PURCHASER)

PATH

—590—

Page 10

x 0.5



BLOCK AREA / BOUNDARY LENGTH

3.5m COMBINED EASEMENT UNO  
(Sewer and Stormwater)

BUSHFIRE ATTACK LEVEL

## DISCUSSION

BLOCK NUMBER

STOP  
TIES

SUBSTATION

400m<sup>2</sup> 4.54

---

BAL 12.5

802



10

## NOTES

1. THIS PLAN ONLY INDICATES AREA OF FILL OF WHICH THE DEVELOPER AND ITS AGENTS ARE AWARE. IT HAS NOT BEEN CHECKED BY THE DEVELOPER, AND THE DEVELOPER DOES NOT GUARANTEE ITS ACCURACY. IN NO WAY SHOULD THIS PLAN BE READ AS A CONCLUSIVE STATEMENT OF THE FULL EXTENT OF THE FILL THAT MAY BE FOUND ON THE WHOLE LAND DEPICTED. LESSEES AND PURCHASERS SHOULD MAKE THEIR OWN INQUIRIES IN REGARD TO THE EXACT DRAINAGE, GEOTECHNICAL AND FILL CONDITIONS AFFECTING THEIR BLOCKS.
2. STREET TREES, STREET LIGHTS AND SUBSTATION LOCATIONS ARE INDICATIVE ONLY.

REVISION: 1

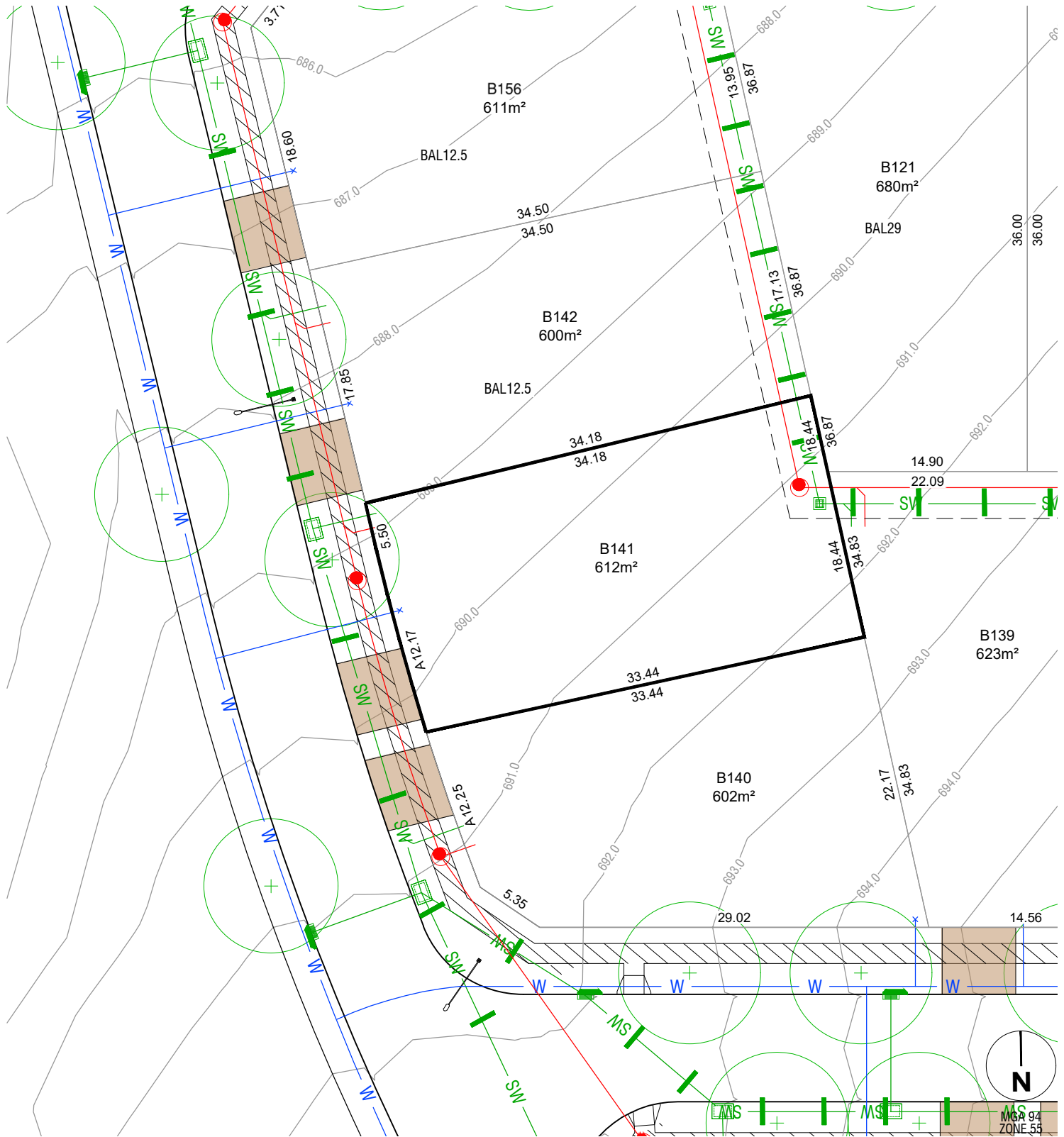

LEGEND

FINISHED SURFACE	590	BLOCK AREA / BOUNDARY LENGTH	400m² 4.54
CONTOURS (1m INTERVAL)		3.5m COMBINED EASEMENT UNO (Sewer and Stormwater)	
FILL		BUSHFIRE ATTACK LEVEL	BAL 12.5
FILL DEPTH (to nearest 100mm)	x 0.5	BLOCK NUMBER	802
STREETLIGHT		STORMWATER, SEWER, WATER TIES	
STREET TREE		SUBSTATION	
DRIVEWAY (BY PURCHASER)			
PATH			

NOTES

1. THIS PLAN ONLY INDICATES AREA OF FILL OF WHICH THE DEVELOPER AND ITS AGENTS ARE AWARE. IT HAS NOT BEEN CHECKED BY THE DEVELOPER, AND THE DEVELOPER DOES NOT GUARANTEE ITS ACCURACY. IN NO WAY SHOULD THIS PLAN BE READ AS A CONCLUSIVE STATEMENT OF THE FULL EXTENT OF THE FILL THAT MAY BE FOUND ON THE WHOLE LAND DEPICTED. LESSEES AND PURCHASERS SHOULD MAKE THEIR OWN INQUIRIES IN REGARD TO THE EXACT DRAINAGE, GEOTECHNICAL AND FILL CONDITIONS AFFECTING THEIR BLOCKS.
2. STREET TREES, STREET LIGHTS AND SUBSTATION LOCATIONS ARE INDICATIVE ONLY.

REVISION: 1

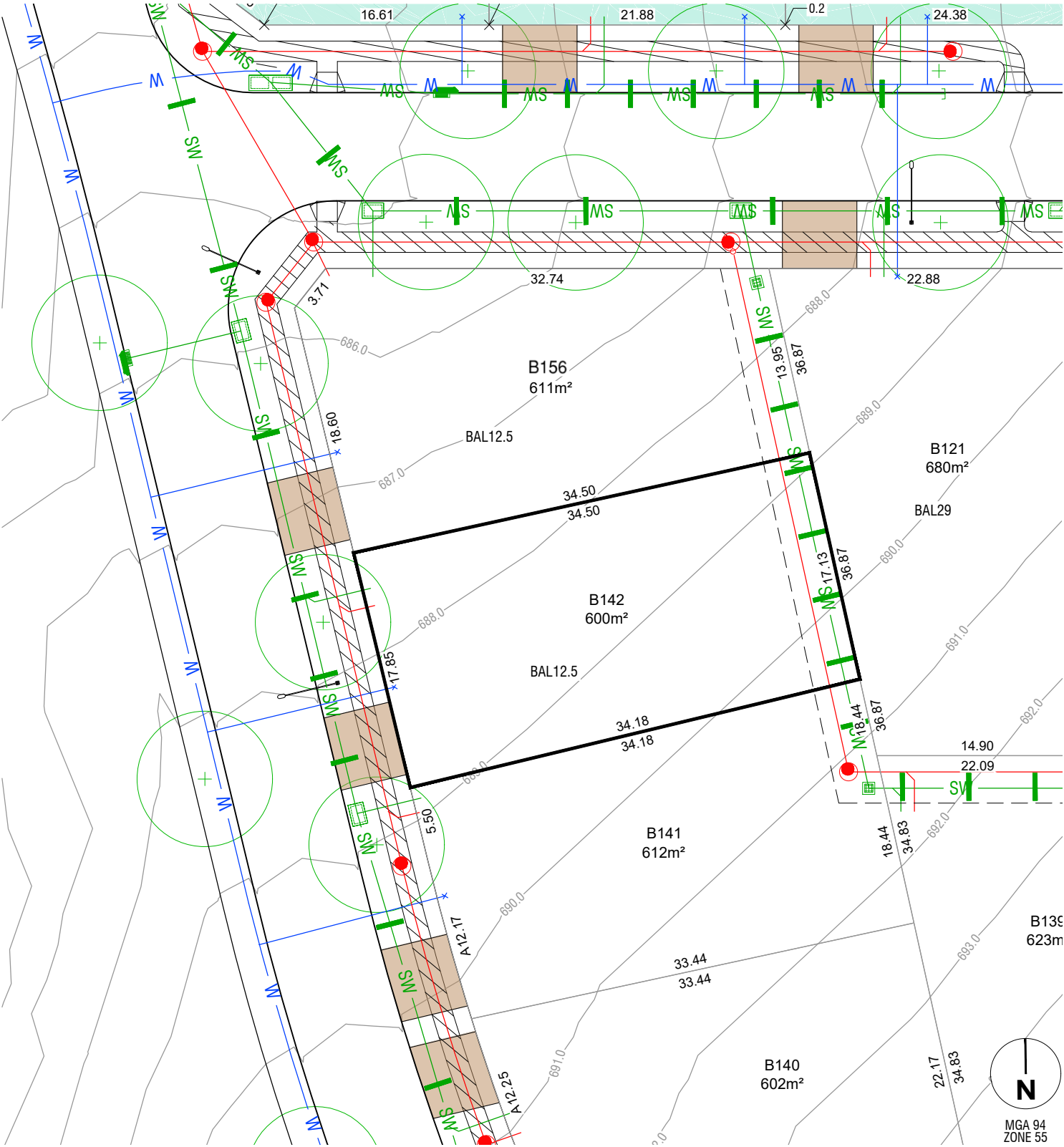

LEGEND

FINISHED SURFACE  
CONTOURS (1m INTERVAL)

590

FILL



FILL DEPTH (to nearest 100mm)

x 0.5

STREETLIGHT



STREET TREE



DRIVEWAY (BY PURCHASER)



PATH



BLOCK AREA / BOUNDARY LENGTH

400m² 4.54

3.5m COMBINED EASEMENT UNO  
(Sewer and Stormwater)



BUSHFIRE ATTACK LEVEL

BAL 12.5

BLOCK NUMBER

802

STORMWATER, SEWER, WATER  
TIES



SUBSTATION



NOTES

1. THIS PLAN ONLY INDICATES AREA OF FILL OF WHICH THE DEVELOPER AND ITS AGENTS ARE AWARE. IT HAS NOT BEEN CHECKED BY THE DEVELOPER, AND THE DEVELOPER DOES NOT GUARANTEE ITS ACCURACY. IN NO WAY SHOULD THIS PLAN BE READ AS A CONCLUSIVE STATEMENT OF THE FULL EXTENT OF THE FILL THAT MAY BE FOUND ON THE WHOLE LAND DEPICTED. LESSEES AND PURCHASERS SHOULD MAKE THEIR OWN INQUIRIES IN REGARD TO THE EXACT DRAINAGE, GEOTECHNICAL AND FILL CONDITIONS AFFECTING THEIR BLOCKS.

2. STREET TREES, STREET LIGHTS AND SUBSTATION LOCATIONS ARE INDICATIVE ONLY.

REVISION: 1

© Spiire Australia Pty Ltd All Rights Reserved

This document is produced by Spiire Australia Pty Ltd solely for the benefit of and use by the client in accordance with the terms of the retainer. Spiire Australia Pty Ltd does not and shall not assume any responsibility or liability whatsoever to any third party arising out of any use or reliance by third party on the content of this document.

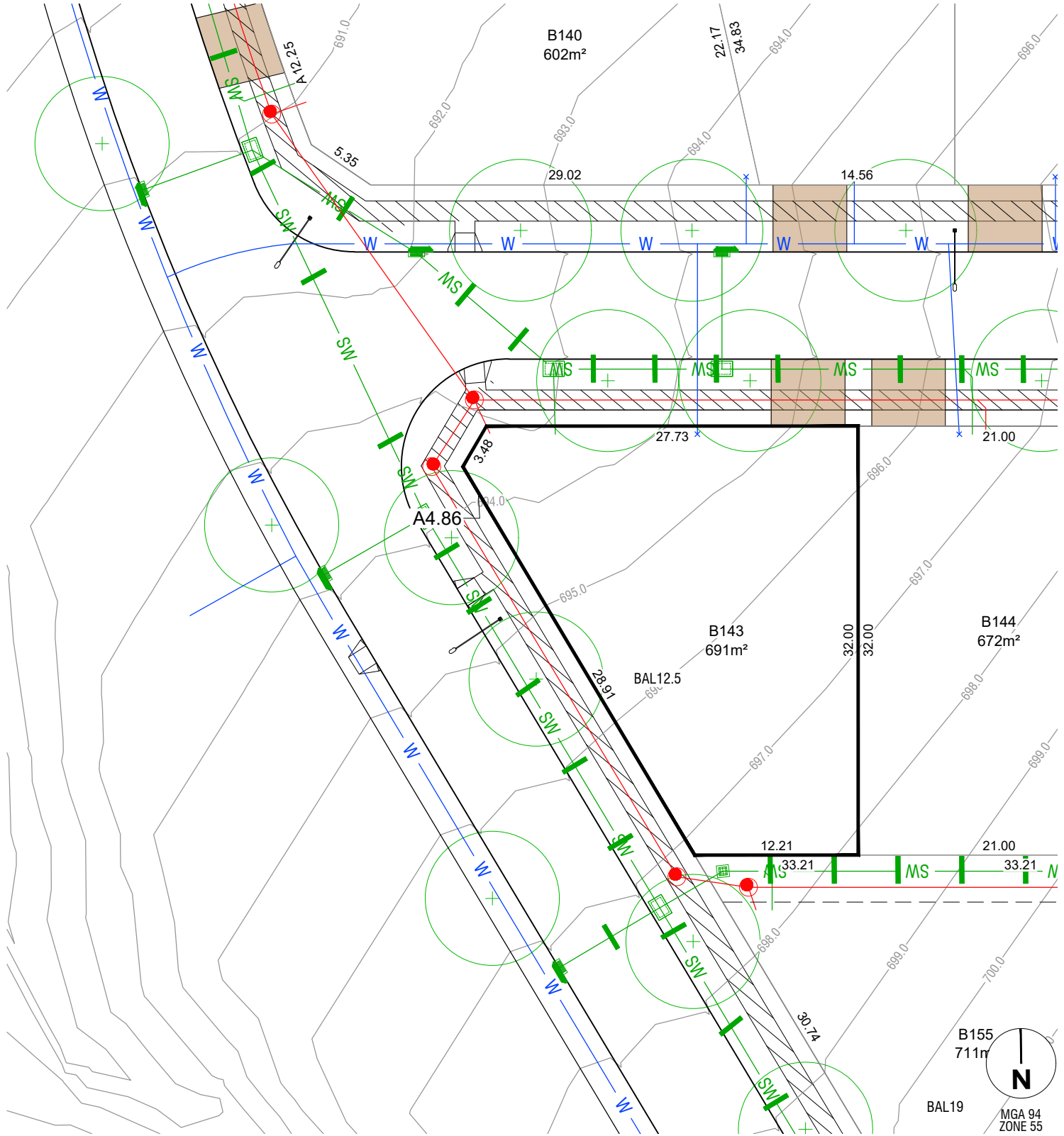

LEGEND

FINISHED SURFACE	590	BLOCK AREA / BOUNDARY LENGTH	400m² 4.54
CONTOURS (1m INTERVAL)		3.5m COMBINED EASEMENT UNO (Sewer and Stormwater)	
FILL		BUSHFIRE ATTACK LEVEL	BAL 12.5
FILL DEPTH (to nearest 100mm)	x 0.5	BLOCK NUMBER	802
STREETLIGHT		STORMWATER, SEWER, WATER TIES	
STREET TREE		SUBSTATION	
DRIVEWAY (BY PURCHASER)			
PATH			

NOTES

- THIS PLAN ONLY INDICATES AREA OF FILL OF WHICH THE DEVELOPER AND ITS AGENTS ARE AWARE. IT HAS NOT BEEN CHECKED BY THE DEVELOPER, AND THE DEVELOPER DOES NOT GUARANTEE ITS ACCURACY. IN NO WAY SHOULD THIS PLAN BE READ AS A CONCLUSIVE STATEMENT OF THE FULL EXTENT OF THE FILL THAT MAY BE FOUND ON THE WHOLE LAND DEPICTED. LESSEES AND PURCHASERS SHOULD MAKE THEIR OWN INQUIRIES IN REGARD TO THE EXACT DRAINAGE, GEOTECHNICAL AND FILL CONDITIONS AFFECTING THEIR BLOCKS.
- STREET TREES, STREET LIGHTS AND SUBSTATION LOCATIONS ARE INDICATIVE ONLY.

REVISION: 1



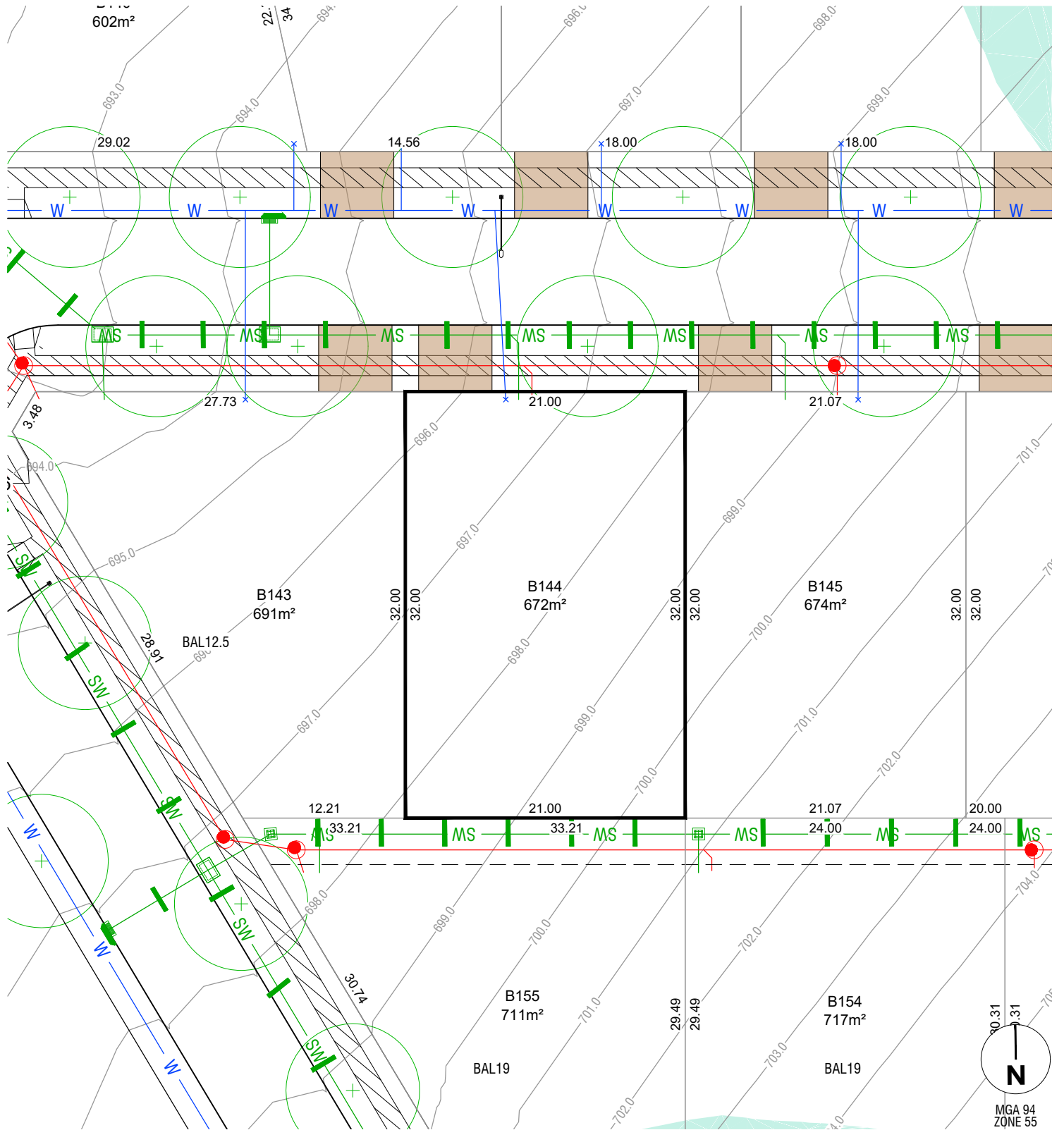

## LEGEND

FINISHED SURFACE	590	BLOCK AREA / BOUNDARY LENGTH	400m² 4.54
CONTOURS (1m INTERVAL)		3.5m COMBINED EASEMENT UNO (Sewer and Stormwater)	
FILL		BUSHFIRE ATTACK LEVEL	BAL 12.5
FILL DEPTH (to nearest 100mm)	x 0.5	BLOCK NUMBER	802
STREETLIGHT		STORMWATER, SEWER, WATER TIES	
STREET TREE		SUBSTATION	
DRIVEWAY (BY PURCHASER)			
PATH			

## NOTES

1. THIS PLAN ONLY INDICATES AREA OF FILL OF WHICH THE DEVELOPER AND ITS AGENTS ARE AWARE. IT HAS NOT BEEN CHECKED BY THE DEVELOPER, AND THE DEVELOPER DOES NOT GUARANTEE ITS ACCURACY. IN NO WAY SHOULD THIS PLAN BE READ AS A CONCLUSIVE STATEMENT OF THE FULL EXTENT OF THE FILL THAT MAY BE FOUND ON THE WHOLE LAND DEPICTED. LESSEES AND PURCHASERS SHOULD MAKE THEIR OWN INQUIRIES IN REGARD TO THE EXACT DRAINAGE, GEOTECHNICAL AND FILL CONDITIONS AFFECTING THEIR BLOCKS.
2. STREET TREES, STREET LIGHTS AND SUBSTATION LOCATIONS ARE INDICATIVE ONLY.

REVISION: 1



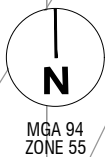

## PATH



SUBSTATION



1. THIS PLAN ONLY INDICATES AREA OF FILL OF WHICH THE DEVELOPER AND ITS AGENTS ARE AWARE. IT HAS NOT BEEN CHECKED BY THE DEVELOPER, AND THE DEVELOPER DOES NOT GUARANTEE ITS ACCURACY. IN NO WAY SHOULD THIS PLAN BE READ AS A CONCLUSIVE STATEMENT OF THE FULL EXTENT OF THE FILL THAT MAY BE FOUND ON THE WHOLE LAND DEPICTED. LESSEES AND PURCHASERS SHOULD MAKE THEIR OWN INQUIRIES IN REGARD TO THE EXACT DRAINAGE, GEOTECHNICAL AND FILL CONDITIONS AFFECTING THEIR BLOCKS.
2. STREET TREES, STREET LIGHTS AND SUBSTATION LOCATIONS ARE INDICATIVE ONLY.

This document is produced by Spiire Australia Pty Ltd solely for the benefit of and use by the client in accordance with the terms of the retainer. Spiire Australia Pty Ltd does not and shall not assume any responsibility or liability whatsoever to any third party arising out of any use or reliance by third party on the content of this document.



## PATH



SUBSTATION



1. THIS PLAN ONLY INDICATES AREA OF FILL OF WHICH THE DEVELOPER AND ITS AGENTS ARE AWARE. IT HAS NOT BEEN CHECKED BY THE DEVELOPER, AND THE DEVELOPER DOES NOT GUARANTEE ITS ACCURACY. IN NO WAY SHOULD THIS PLAN BE READ AS A CONCLUSIVE STATEMENT OF THE FULL EXTENT OF THE FILL THAT MAY BE FOUND ON THE WHOLE LAND DEPICTED. LESSEES AND PURCHASERS SHOULD MAKE THEIR OWN INQUIRIES IN REGARD TO THE EXACT DRAINAGE, GEOTECHNICAL AND FILL CONDITIONS AFFECTING THEIR BLOCKS.
2. STREET TREES, STREET LIGHTS AND SUBSTATION LOCATIONS ARE INDICATIVE ONLY.

© Spiire Australia Pty Ltd All Rights Reserved

© Spiire Australia Pty Ltd All Rights Reserved  
This document is produced by Spiire Australia Pty Ltd solely for the benefit of and use by the client in accordance with the terms of the retainer. Spiire Australia Pty Ltd does not and shall not assume any responsibility or liability whatsoever to any third party arising out of any use or reliance by third party on the content of this document.





## PATH



SUBSTATION



2. STREET TREES, STREET LIGHTS AND SUBSTATION LOCATIONS ARE INDICATIVE ONLY.

This document is produced by Spiire Australia Pty Ltd solely for the benefit of and use by the client in accordance with the terms of the retainer. Spiire Australia Pty Ltd does not and shall not assume any responsibility or liability whatsoever to any third party arising out of any use or reliance by third party on the content of this document.



## PATH



SUBSTATION



2. STREET TREES, STREET LIGHTS AND SUBSTATION LOCATIONS ARE INDICATIVE ONLY.

This document is produced by Spiire Australia Pty Ltd solely for the benefit of and use by the client in accordance with the terms of the retainer. Spiire Australia Pty Ltd does not and shall not assume any responsibility or liability whatsoever to any third party arising out of any use or reliance by third party on the content of this document.



## PATH



SUBSTATION



2. STREET TREES, STREET LIGHTS AND SUBSTATION LOCATIONS ARE INDICATIVE ONLY.

© Spiire Australia Pty Ltd All Rights Reserved

This document is produced by Spiire Australia Pty Ltd solely for the benefit of and use by the client in accordance with the terms of the retainer. Spiire Australia Pty Ltd does not and shall not assume any responsibility or liability whatsoever to any third party arising out of any use or reliance by third party on the content of this document.

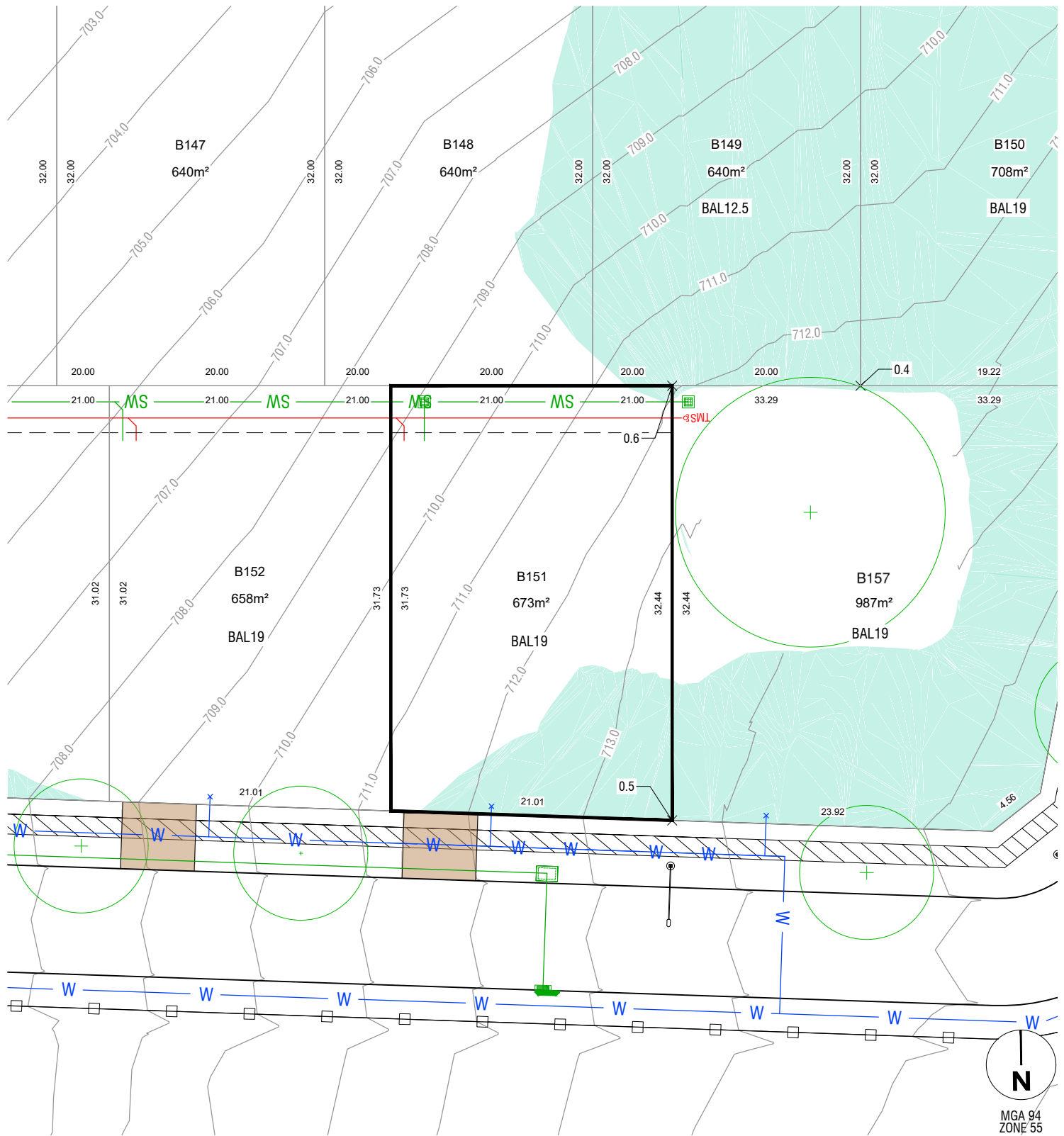

## LEGEND

FINISHED SURFACE	— 590 —	BLOCK AREA / BOUNDARY LENGTH	400m² 4.54
CONTOURS (1m INTERVAL)		3.5m COMBINED EASEMENT UNO (Sewer and Stormwater)	
FILL		BUSHFIRE ATTACK LEVEL	BAL 12.5
FILL DEPTH (to nearest 100mm)	x 0.5	BLOCK NUMBER	802
STREETLIGHT	—	STORMWATER, SEWER, WATER TIES	
STREET TREE	—	SUBSTATION	
DRIVEWAY (BY PURCHASER)			
PATH			

## NOTES

- THIS PLAN ONLY INDICATES AREA OF FILL OF WHICH THE DEVELOPER AND ITS AGENTS ARE AWARE. IT HAS NOT BEEN CHECKED BY THE DEVELOPER, AND THE DEVELOPER DOES NOT GUARANTEE ITS ACCURACY. IN NO WAY SHOULD THIS PLAN BE READ AS A CONCLUSIVE STATEMENT OF THE FULL EXTENT OF THE FILL THAT MAY BE FOUND ON THE WHOLE LAND DEPICTED. LESSEES AND PURCHASERS SHOULD MAKE THEIR OWN INQUIRIES IN REGARD TO THE EXACT DRAINAGE, GEOTECHNICAL AND FILL CONDITIONS AFFECTING THEIR BLOCKS.
- STREET TREES, STREET LIGHTS AND SUBSTATION LOCATIONS ARE INDICATIVE ONLY.

REVISION: 3





## PATH



SUBSTATION



2. STREET TREES, STREET LIGHTS AND SUBSTATION LOCATIONS ARE INDICATIVE ONLY.

This document is produced by Spiire Australia Pty Ltd solely for the benefit of and use by the client in accordance with the terms of the retainer. Spiire Australia Pty Ltd does not and shall not assume any responsibility or liability whatsoever to any third party arising out of any use or reliance by third party on the content of this document.

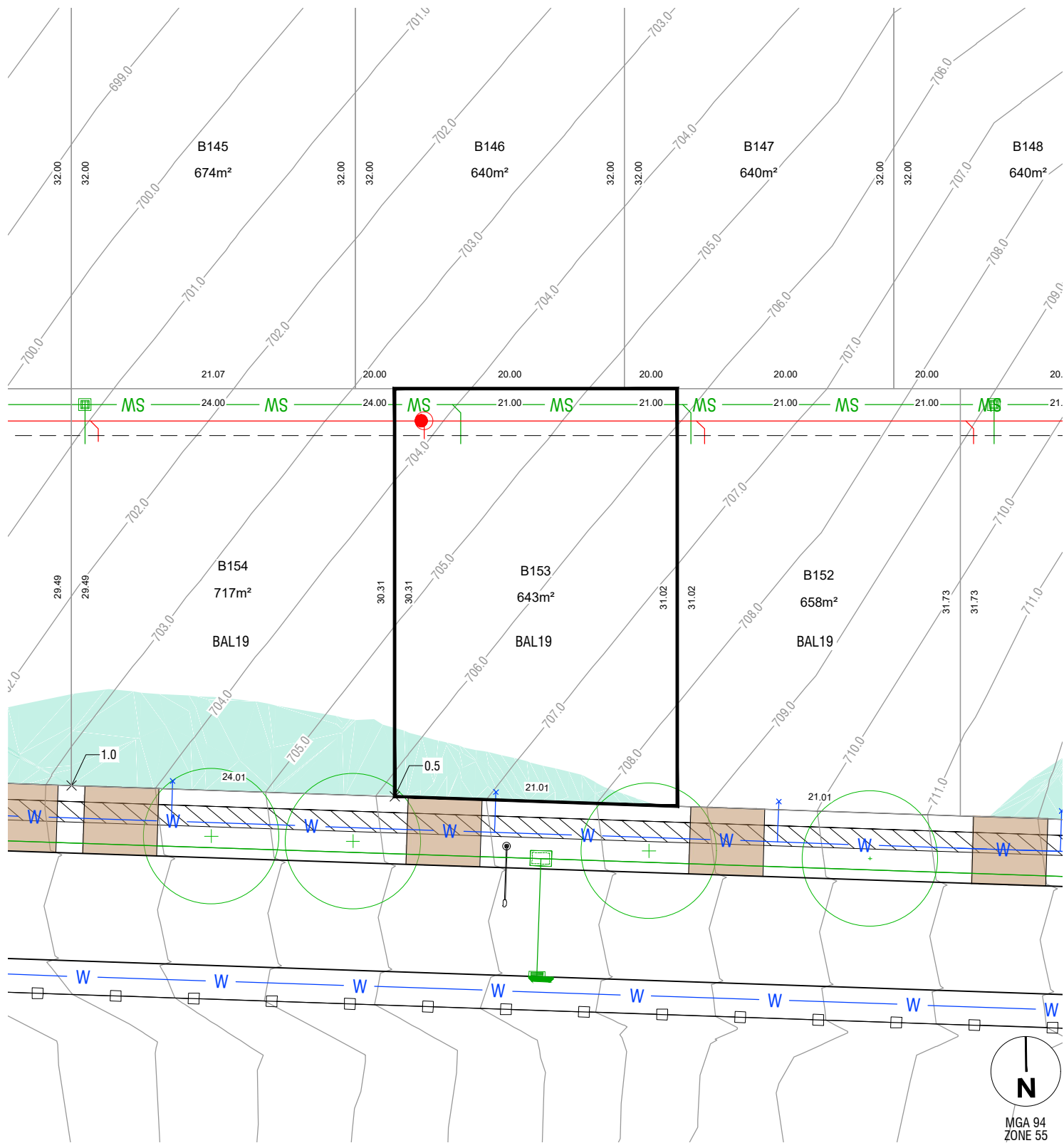

LEGEND

FINISHED SURFACE	590	BLOCK AREA / BOUNDARY LENGTH	400m <sup>2</sup> 4.54
CONTOURS (1m INTERVAL)		3.5m COMBINED EASEMENT UNO (Sewer and Stormwater)	
FILL		BUSHFIRE ATTACK LEVEL	BAL 12.5
FILL DEPTH (to nearest 100mm)	x 0.5	BLOCK NUMBER	802
STREETLIGHT		STORMWATER, SEWER, WATER TIES	
STREET TREE		SUBSTATION	
DRIVEWAY (BY PURCHASER)			
PATH			

NOTES

- THIS PLAN ONLY INDICATES AREA OF FILL OF WHICH THE DEVELOPER AND ITS AGENTS ARE AWARE. IT HAS NOT BEEN CHECKED BY THE DEVELOPER, AND THE DEVELOPER DOES NOT GUARANTEE ITS ACCURACY. IN NO WAY SHOULD THIS PLAN BE READ AS A CONCLUSIVE STATEMENT OF THE FULL EXTENT OF THE FILL THAT MAY BE FOUND ON THE WHOLE LAND DEPICTED. LESSEES AND PURCHASERS SHOULD MAKE THEIR OWN INQUIRIES IN REGARD TO THE EXACT DRAINAGE, GEOTECHNICAL AND FILL CONDITIONS AFFECTING THEIR BLOCKS.
- STREET TREES, STREET LIGHTS AND SUBSTATION LOCATIONS ARE INDICATIVE ONLY.

REVISION: 2

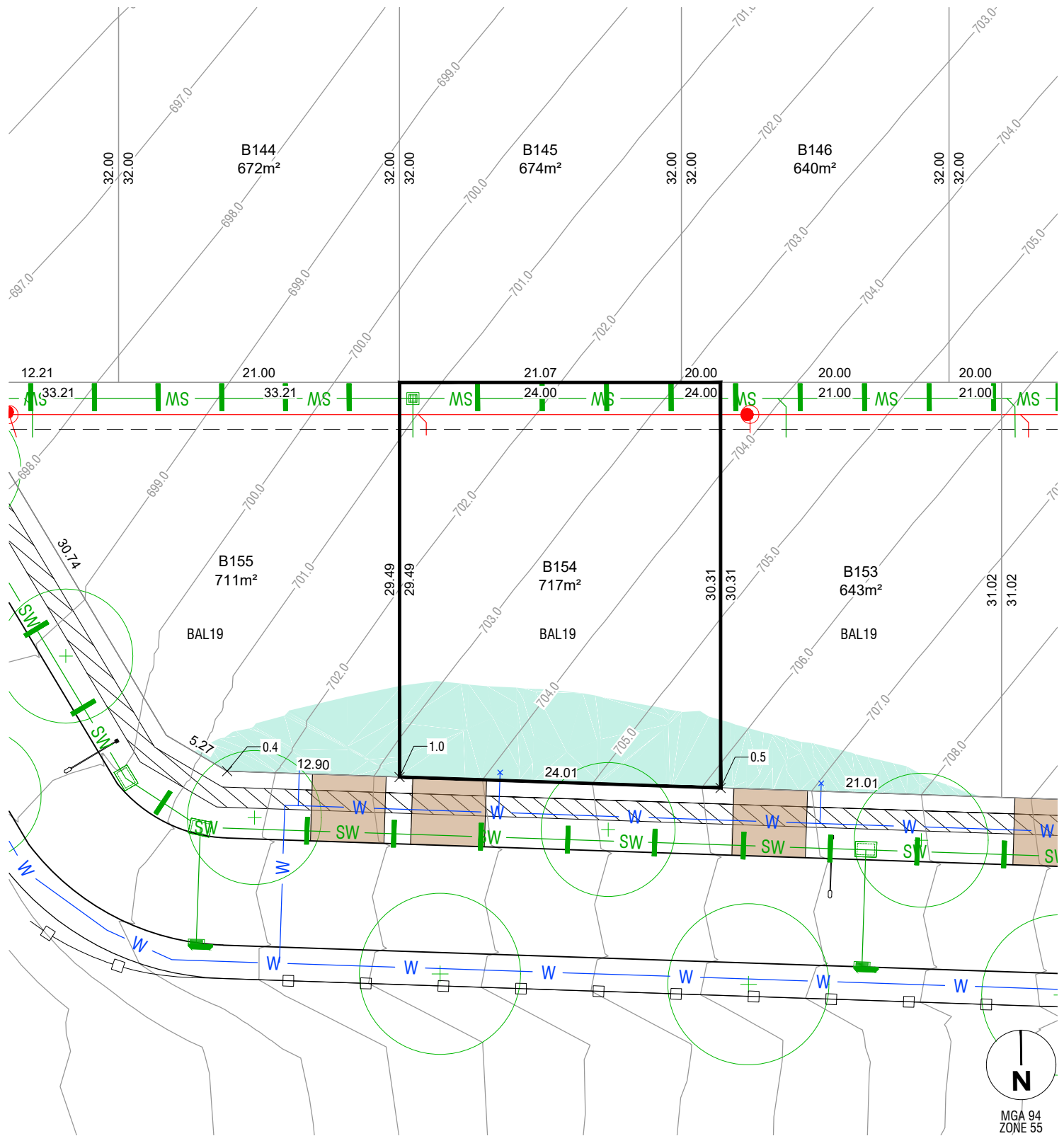

### LEGEND

FINISHED SURFACE  
CONTOURS (1m INTERVAL)

FILL

FILL DEPTH (to nearest 100mm)

STREETLIGHT

STREET TREE

DRIVEWAY (BY PURCHASER)

PATH

—590—

---

x 0.5



BLOCK AREA / BOUNDARY LENGTH

3.5m COMBINED EASEMENT UNO  
(Sewer and Stormwater)

BUSHFIRE ATTACK LEVEL

BLOCK NUMBER

STORMWATER, SEWER, WATER  
TIES

SUBSTATION

400m<sup>2</sup> 4.54

---

BAL 12.5

802



## NOTES

1. THIS PLAN ONLY INDICATES AREA OF FILL OF WHICH THE DEVELOPER AND ITS AGENTS ARE AWARE, IT HAS NOT BEEN CHECKED BY THE DEVELOPER, AND THE DEVELOPER DOES NOT GUARANTEE ITS ACCURACY. IN NO WAY SHOULD THIS PLAN BE READ AS A CONCLUSIVE STATEMENT OF THE FULL EXTENT OF THE FILL THAT MAY BE FOUND ON THE WHOLE LAND DEPICTED. LESSEES AND PURCHASERS SHOULD MAKE THEIR OWN INQUIRIES IN REGARD TO THE EXACT DRAINAGE, GEOTECHNICAL AND FILL CONDITIONS AFFECTING THEIR BLOCKS.
2. STREET TREES, STREET LIGHTS AND SUBSTATION LOCATIONS ARE INDICATIVE ONLY.

REVISION: 1

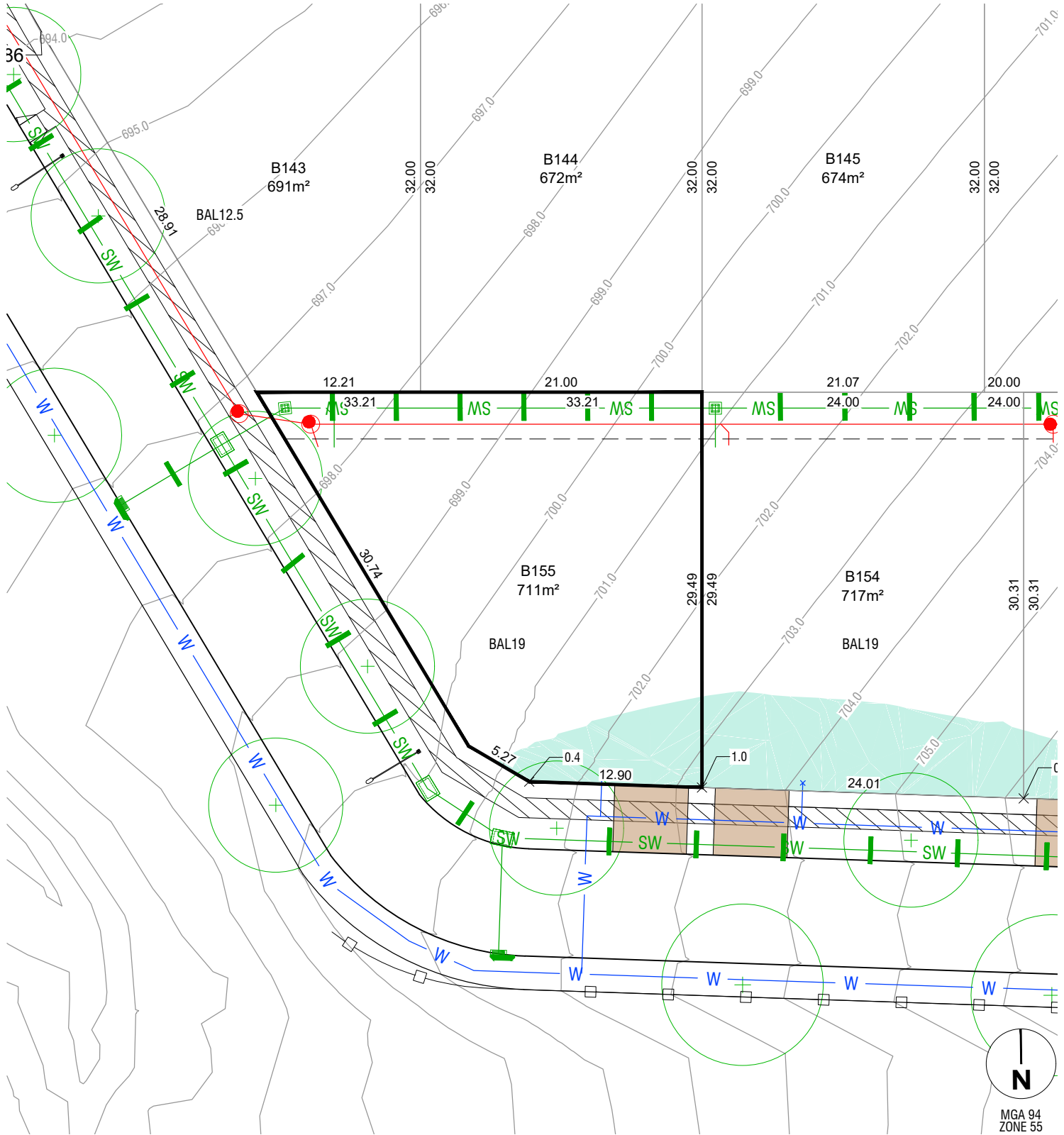

LEGEND

FINISHED SURFACE	590	BLOCK AREA / BOUNDARY LENGTH	400m² 4.54
CONTOURS (1m INTERVAL)		3.5m COMBINED EASEMENT UNO (Sewer and Stormwater)	
FILL		BUSHFIRE ATTACK LEVEL	BAL 12.5
FILL DEPTH (to nearest 100mm)	x 0.5	BLOCK NUMBER	802
STREETLIGHT		STORMWATER, SEWER, WATER TIES	
STREET TREE		SUBSTATION	
DRIVEWAY (BY PURCHASER)			
PATH			

NOTES

- THIS PLAN ONLY INDICATES AREA OF FILL OF WHICH THE DEVELOPER AND ITS AGENTS ARE AWARE. IT HAS NOT BEEN CHECKED BY THE DEVELOPER, AND THE DEVELOPER DOES NOT GUARANTEE ITS ACCURACY. IN NO WAY SHOULD THIS PLAN BE READ AS A CONCLUSIVE STATEMENT OF THE FULL EXTENT OF THE FILL THAT MAY BE FOUND ON THE WHOLE LAND DEPICTED. LESSEES AND PURCHASERS SHOULD MAKE THEIR OWN INQUIRIES IN REGARD TO THE EXACT DRAINAGE, GEOTECHNICAL AND FILL CONDITIONS AFFECTING THEIR BLOCKS.
- STREET TREES, STREET LIGHTS AND SUBSTATION LOCATIONS ARE INDICATIVE ONLY.

REVISION: 1



file name 320895 SOUTH JERRABOMBERRA STAGE 2B OVERALL.dwg, layout name SP000, plotted by Jim Zhang  
file location \\spire\caddata\320895\001 Civil\CAD\Sales Plans plot date 01/05/2024 10:27 AM Sheet 1 of 1  
Sheets

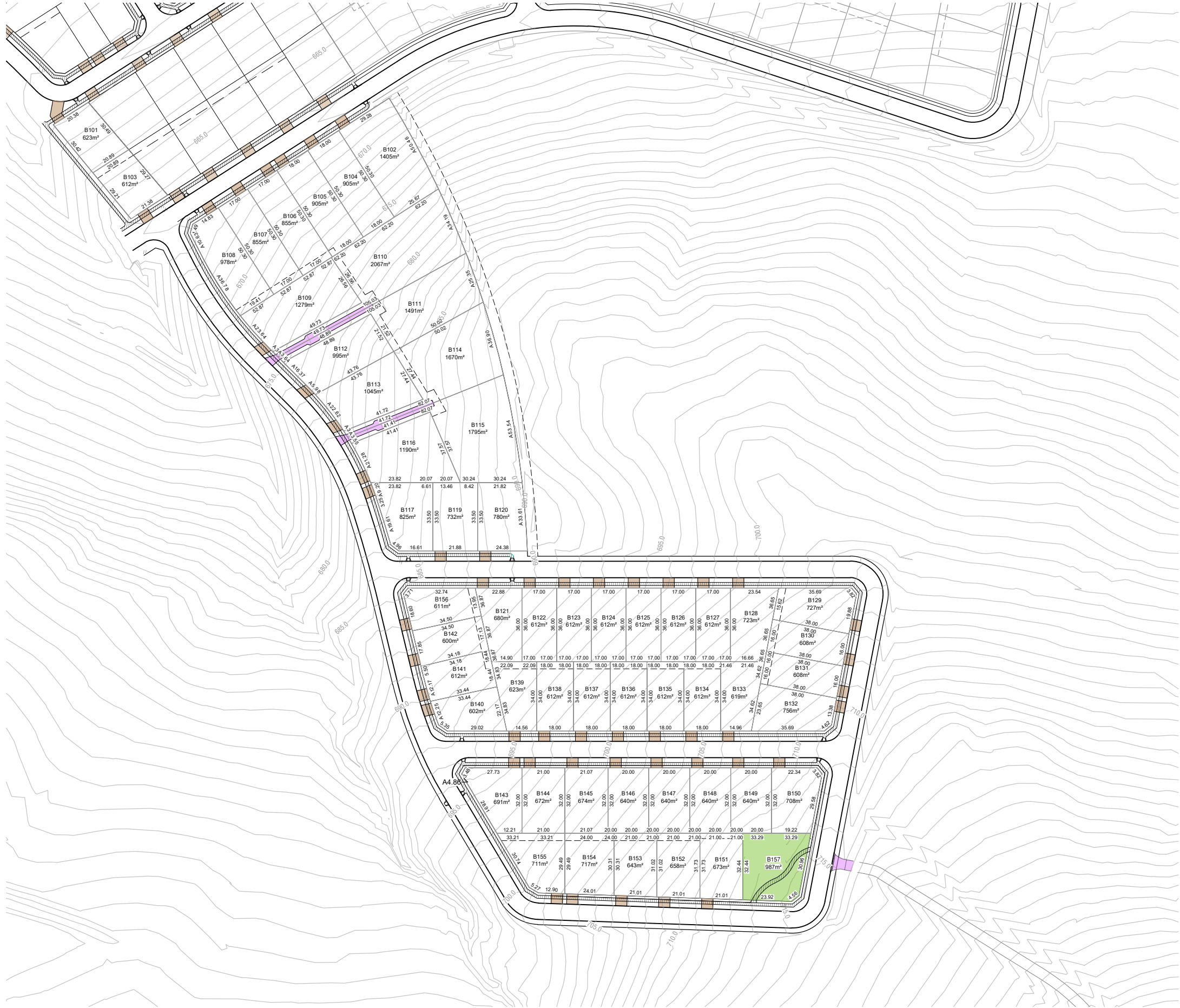

LEGEND

- FINISHED SURFACE
- CONTOURS (1m INTERVAL)
- DRIVEWAY LOCATION
- SHARED DRIVEWAY (BY CONTRACTOR)
- PATH
- OPEN SPACE

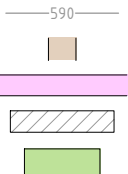

BLOCK AREA / BOUNDARY LENGTH  
3.5m COMBINED EASEMENT (Sewer and Stormwater)

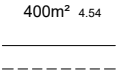

BLOCK NUMBER

802

Rev	Amendments	Approved	Date
B	LOTING CHANGES	TW	MARCH 24
A	ISSUED TO CLIENT	TW	FEB 24

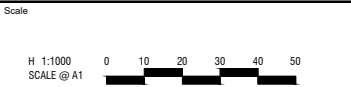

© Spiire Australia Pty Ltd All Rights Reserved  
This document is produced by Spiire Australia Pty Ltd solely for the benefit of and use by the client in accordance with the terms of the retainer. Spiire Australia Pty Ltd does not and shall not assume any responsibility or liability whatsoever to any third party arising out of any use or reliance by third party on the content of this document.



Suite 5, Level 1, 243 Northbourne Avenue  
Lyneham ACT 2602 Australia T 02 6102 1000  
spiire.com.au ABN 55 050 029 635



Designed Checked  
Authorised Date

SOUTH JERRABOMBERRA  
STAGE 2B  
SALES PLANS

THE VILLAGE BUILDING CO

Dwg No

320895SP000

Rev

B